



IPA INTERNATIONAL PSYCHOGERIATRIC ASSOCIATION
International Congress

6-9 September 2016

Towards Mental Health Care for all Older Adults



Final Program

#IPASanFran2016



ABOUT IPA

Founded in 1982, the International Psychogeriatric Association (IPA) is a unique and diverse professional healthcare community promoting better geriatric mental health – across disciplines, across borders, and across geriatric issues. Psychiatrists, Scientists, Neurologists, Geriatricians, Primary Care Physicians, Epidemiologists, Nurses, Psychologists, Occupational Therapists, Social Workers and many other healthcare professionals come to the IPA community from all over the world to discuss, learn, share and research information about behavioral and biological aspects of geriatric mental health.

IPA Member Benefits

- Subscription to *International Psychogeriatrics*, IPA's multidisciplinary peer-reviewed journal published monthly
- Subscription to the *IPA Bulletin*, IPA's membership newsletter
- Reduced rates and access to IPA congress and meetings
- IPA Online – the IPA website – including the IPA Member Area with special features including access to fellow members and *The IPA Complete Guide to Behavioral and Psychological Symptoms of Dementia (BPSD)*
- Participation in IPA Member Forums, IPA's in-person and online groups which enable members to meet, communicate, and collaborate with IPA colleagues around the world. Groups include: Regional Initiative Forums (groups by geographic areas); Professional Discipline Forums (groups such as nurses, psychologists, primary care physicians, social workers, and occupational therapists); and Shared Interest Forums (interest groups including long term care, young onset dementia, testamentary capacity and others)

IPA Board of Directors

OFFICERS

Raimundo Mateos, President, Spain

Mary Sano, President-Elect, United States

Huali Wang, Secretary, PR China

Constantine G. Lyketsos, Treasurer, United States

Henry Brodaty, Immediate Past President, Australia

DIRECTORS

Sabine Bährer-Kohler, Switzerland

David Conn, Canada

Brian Draper, Australia

Ryo Fukatsu, Japan

Venu Gopal Jhanwar, India

Wendy Moyle, Australia

EX OFFICIO

Manabu Ikeda, Japan

IPA SECRETARIAT

Kate Filipiak, CAE, Executive Director

Kristen McGuire, CMP, Senior Meetings Manager

Laura C. Olsen, JD, Membership and Communications Manager

TABLE OF CONTENTS

Welcome Message	2
Congress Committees	3
Sponsors	4
2016 Awards	5
Schedule-at-a-Glance	6
General Information	7
Keynote and Plenary Speakers	8
IPA Member Forums	9
Pre-Congress Workshops	10
Scientific Program	10
Posters	19
Exhibits	24

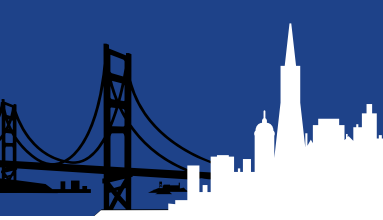

WELCOME MESSAGE

Dear Colleagues,

On behalf of IPA and Congress Organizing Committee co-chairs, Helen Lavretsky and Lon Schneider we are excited to welcome you to the 2016 IPA International Congress in San Francisco, CA. This year we celebrate the 18th year of bringing together a global network of professionals in the field of psychogeriatrics to the IPA International Congresses.

The theme of the Congress, *Towards Mental Health Care for all Older Adults*, will feature world-renowned professionals sharing their knowledge and expertise in workshops, plenaries, symposia, free/oral communication, posters and more. The Scientific Committee, under the leadership of co-chairs, Martin Prince and Heii Arai, developed a strong and interdisciplinary scientific program. A special thank you to all of the committee members that helped contribute to the program; your dedication to IPA is greatly appreciated.

I look forward to meeting you at the many educational and networking events throughout the Congress!

Warm Regards,



Raimundo Mateos
IPA President



CONGRESS COMMITTEES

Dear Colleagues,

It gives us great pleasure to join IPA President, Raimundo Mateos, in welcoming you to the 2016 IPA International Congress in San Francisco, CA.

In the past decade, the field of geriatric mental health has grown to embrace global health and solutions to global aging by promising cures for major neuropsychiatric disorders of aging that can improve lives of our patients and their families. Improved understanding of the biology of Alzheimer's and other dementia causing diseases, late life depression and suicide, sleep disorders, anxiety disorders, delirium and others, provides an optimistic view that, at least in some cases, "cures" might be forthcoming in the professional lifetimes of younger IPA members. At the same time, global aging will increase numbers of older people who will require mental health care in the decades to come. Hence, responsibility of the international and multidisciplinary field of Psychogeriatrics is to balance care for all of our patients and their families without exception and increase access to care for all older adults around the world.

This year's IPA Congress focuses on the main theme of accessibility to mental health services for older adults to improve treatment and prevention of the neuropsychiatric disorders of aging. We have selected a keynote, plenaries, symposia, free communication and poster sessions on topics that encompass the broad spectrum of Psychogeriatrics ranging from understanding novel neuroimaging methods, to methods of conducting clinical trials and advances in drug development, to the medicolegal issues of capacity assessment. These are just a few of the exciting topics of discussion that will be at the 2016 International Congress.

We hope that you will take this opportunity to expand your knowledge and broaden your professional networks during daily sessions and local programs. You will learn something new and experience the diversity of topics and backgrounds that makes the IPA community so unique. We look forward to seeing you at the many educational symposia, poster sessions, workshops and site visits to local care facilities.

On behalf of the members of the Organizing Committee, Scientific Committee and Local Organizing Committee, we wish you a pleasurable and informative few days during this Congress. Thank you for joining us!



Helen Lavretsky



Lon Schneider



Martin Prince



Heii Arai



Jay Luxenberg

Organizing Committee

Helen Lavretsky, Co-Chair, United States
Lon Schneider, Co-Chair, United States
Raimundo Mateos, Spain
Mary Sano, United States
Martin Prince, United Kingdom
Heii Arai, Japan
Jay Luxenberg, United States
Maria Lapid, United States

Scientific Committee

Martin Prince, Co-Chair, United Kingdom
Heii Arai, Co-Chair, Japan
Raimundo Mateos, Spain
Helen Lavretsky, United States
Lon Schneider, United States
Henry Brodaty, Australia
Dilip Jeste, United States
Beth Galik, United States
Shabbir Amanullah, Canada
Wendy Moyle, United States
Jerson Laks, Brazil
Knut Engedal, Norway
Bruce Miller, United States
Olusegun Baiyewu, Nigeria
Victor Valcour, United States
David Conn, Canada
Edgardo Reich, Argentina
Gwenn Smith, United States
Adriana Hermida, United States
Daisy Acosta, Dominican Republic

Local Organizing Committee

Jay Luxenberg, United States, Chair
Elliott Stein, United States
Irena Ginsburg, United States
Denise Rettenmaier, United States
Caroline Stephens, United States
Mary De May, United States
Laura Dunn, United States
Kristine Yaffe, United States



SPONSORSHIP

IPA would like to thank the following for their support of the 2016 IPA International Congress:

American Psychological Association – General Meeting Support

Avanir Pharmaceuticals, Inc. – WiFi Sponsor; Clinical Trials Pre-Congress Workshop

Biogen – General Meeting Support

Lundbeck – General Meeting Support

vTv Therapeutics – Clinical Trials Pre-Congress Workshop

Join IPA in Taipei

9-11 December 2016

Safety and Integrated Care in Aging Mental Health: Cross-cultural Perspectives



2016 IPA
International Psychogeriatric Association
Asian Regional Meeting
9-11 December 2016, Taipei, Taiwan
Safety and Integrated Care in Aging Mental Health: Cross-cultural Perspectives



2016 IPA AWARDS

2016 IPA Junior Research Awards in Psychogeriatrics

Presented in conjunction with IPA Congresses, the IPA Junior Research Awards in Psychogeriatrics are an example of IPA's commitment to presenting groundbreaking work to its members and developing new leaders. These prestigious awards were created to encourage and reward junior researchers and recognize the best, original, unpublished research in the field of Psychogeriatrics.

We applaud all of those who submitted their work and we encourage everyone to attend the Junior Research Award winner's session taking place on Wednesday, 7 September from 13:15 - 14:45 in Continental Ballroom 7-8.

First Place Winner

Elijah Mak, United Kingdom

Multi-modal MRI investigation of volumetric and microstructural changes in the hippocampus and its subfields in mild cognitive impairment, Alzheimer's disease, and dementia with Lewy bodies

Second Place Winner

Harris Eyre, Australia

A randomized controlled trial of Kundalini yoga in mild cognitive impairment

Third Place Winner

Sarah Robertson, United Kingdom

Proxy rated quality of life of care home residents with dementia: A systematic review

We want to express our sincere appreciation to the Junior Research Award selection committee for their conscientious work:

Nicola Lautenschlager, Australia

Martin Cole, Canada

Mary Ganguli, United States

Huali Wang, PR China

Leon Flicker, Australia

Helen Chiu, Hong Kong

2016 Distinguished Service Awards

Service to the Field of Psychogeriatrics

Charles Reynolds III, United States

Myrra Vernooij-Dassen, The Netherlands

Service to Congress Host Country (United States)

Lon Schneider, United States

Mary Mittelman, United States

Service to the International Psychogeriatric Association (IPA)

Nicola Lautenschlager, Australia

Congratulations to all of the 2016 Award Winners!



SCHEDULE-AT-A-GLANCE

Tuesday, 6 September

- 08:30 – 17:00 3rd International Conference on Capacity
- 08:30 – 16:30 Imaging and Biomarkers Workshop
- 09:00 – 16:30 How to Conduct Clinical Trials in Geriatric Psychiatry Workshop
- 15:30 – 17:00 World Health Organization (WHO) Session
- 17:00 – 19:00 Opening Session and Keynote Lecture: Victor Valcour and Tarun Dua
- 19:00 – 20:30 Opening Reception

Wednesday, 7 September

- 08:30 – 09:30 Plenary I: Sube Banerjee
- 09:30 – 10:00 Morning Break
- 10:00 – 11:30 Concurrent Scientific Sessions I
- 11:30 – 13:00 Lunch and Poster Presentations
- 13:15 – 14:45 Concurrent Scientific Sessions II
- 14:45 – 15:15 Afternoon Break
- 15:15 – 16:45 Concurrent Scientific Sessions III
- 17:00 – 18:00 Plenary II: Dilip Jeste
- 18:00 – 18:30 IPA Members Annual Business Meeting

Thursday, 8 September

- 08:30 – 09:30 Plenary III: Olusegun Baiyewu and Cleusa Ferri
- 09:30 – 10:00 Morning Break
- 10:00 – 11:30 Concurrent Scientific Sessions IV
- 11:30 – 13:00 Lunch and Poster Presentations
- 13:15 – 14:45 Concurrent Scientific Sessions V
- 14:45 – 15:15 Afternoon Break
- 15:15 – 16:15 Plenary IV: Miia Kivipelto and Edo Richard
- 16:30 – 17:30 IPA Professional Discipline Forums

Friday, 9 September

- 08:30 – 09:30 Plenary V: Charles Reynolds, III
- 09:30 – 10:00 Morning Break
- 10:00 – 11:30 Concurrent Scientific Sessions VI
- 11:30 – 13:00 Lunch
- 13:00 – 16:30 Long Term Care Site Visits
- 13:15 – 14:45 Concurrent Scientific Sessions VII
- 14:45 – 15:15 Afternoon Break
- 15:15 – 16:45 Concurrent Scientific Sessions VIII

GENERAL INFORMATION

About San Francisco

San Francisco is home to famous attractions such as the Golden Gate Bridge, Fisherman's Wharf, and Alcatraz to name a few. Take a ride on a cable car trolley, eat at one of the thousands of restaurants or do some shopping. San Francisco has something to offer everyone. Visit www.sanfrancisco.travel for additional information.

Registration Desk

The registration desk is located in the East Lounge and will be open during the following dates and times:

Monday, 5 September	16:00 – 19:00
Tuesday, 6 September	07:30 – 20:00
Wednesday, 7 September	07:30 – 18:30
Thursday, 8 September	07:30 – 18:00
Friday, 9 September	08:00 – 15:30

Exhibition Hall and Poster Hall

The exhibition and poster hall is located in the Golden Gate Ballroom and will be open during the following dates and times:

Tuesday, 6 September	16:00 - 20:30
Wednesday, 7 September	09:30 – 18:00
Thursday, 8 September	09:30 – 18:00

* Poster presentations take place on Wednesday and Thursday from 11:30 – 13:00. See page 20 for additional information on posters. See page 25 for additional information on exhibitors.

Badges

Delegates and guests are requested to wear their name badges at all times during the congress and social events, for security reasons.

Certificate of Attendance

If you require a certificate of attendance, please email info@ipa-online.org and we will email you one after the Congress.

Wi-Fi Internet

Wireless internet service is available throughout the hotel and is free of charge.

Network: Hilton-Events
Password: IPAIC2016

* Wi-Fi internet is sponsored by *Avanir Pharmaceuticals, Inc.*

Meeting Room Protocol

Every effort will be made to ensure that sessions start and end on time. Presenters and congress delegates are all asked to work together to achieve this. This may mean having to quickly end a valuable discussion. However, the Congress organizers request cooperation for the benefit of all delegates and hope you will take the opportunity to continue discussions after session outside of the room.

You are not permitted to make sound or video recordings, or take photographs during sessions. We request that all mobile phones and/or pagers be turned off or set to silent before entering sessions.

Dress Code

Business casual attire is requested for all scientific sessions and functions, unless otherwise stated.

Venue Floorplans

BALLROOM LEVEL

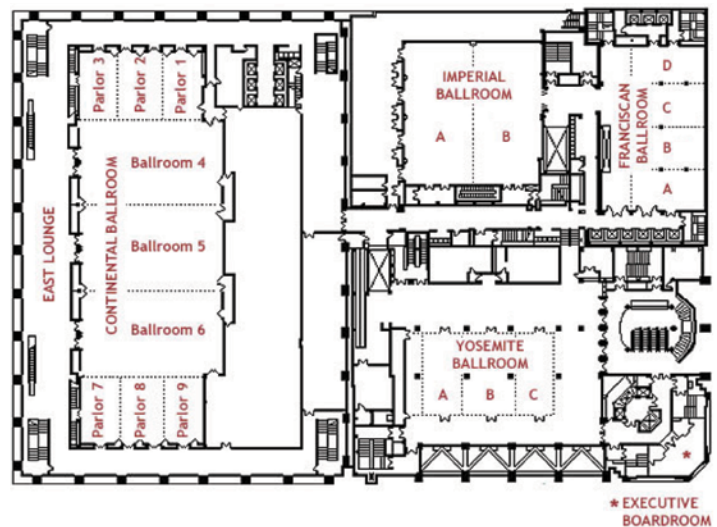

FOURTH FLOOR – UNION SQUARE ROOMS

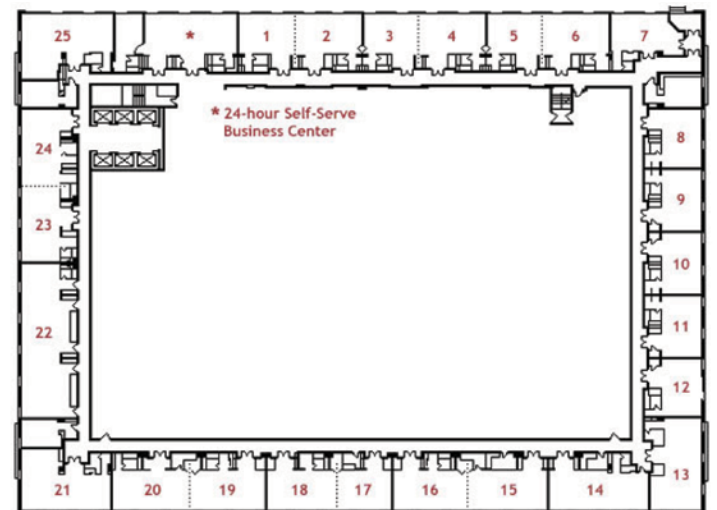



KEYNOTE & PLENARY SPEAKERS



Victor Valcour, United States
Progress in Global Mental Health for Elders
Tuesday, 6 September
17:00 – 19:00
Continental Ballroom 5



Cleusa Ferri, Brazil
Mental Health Care for Older Adults in South America
Thursday, 8 September
08:30 – 09:30
Continental Ballroom 5



Tarun Dua, Switzerland
Public Health Response to Dementia
Tuesday, 6 September
17:00 – 19:00
Continental Ballroom 5



Miia Kivipelto, Sweden
Dementia Prevention among at Risk Persons
Thursday, 8 September
15:15 – 16:15
Continental Ballroom 5



Sube Banerjee
Dementia: Strategies for Success
Tuesday, 6 September
08:30 – 09:30
Continental Ballroom 5



Edo Richard, The Netherlands
Dementia Prevention from a Population Perspective
Thursday, 8 September
15:15 – 16:15
Continental Ballroom 5



Dilip Jeste, United States
Positive Psychiatry
Wednesday, 7 September
17:00 – 18:00
Continental Ballroom 5



Charles Reynolds, III, United States
Prevention of Late-Life Depression & Anxiety in Low & Middle Income Countries: An Intervention Development Project (DIL)
Friday, 9 September
08:30 – 09:30
Continental Ballroom 5



Olusegun Baiyewu, Nigeria
Thursday, 8 September
08:30 – 09:30
Continental Ballroom 5

IPA MEMBER FORUMS

These discussion groups will meet during the congress to work and interact based on similar professional areas and shared interest areas. After the congress, the discussion groups will continue to collaborate via the IPA Members area and the IPA website.

Professional Discipline Forums

THURSDAY, 8 SEPTEMBER

16:30 – 17:30

Psychologists	Continental Ballroom 1-2
Occupational Therapists/Social Workers	Continental Ballroom 3
Nurses	Continental Ballroom 5
Primary Care Physicians	Continental Ballroom 7-8

In addition to the Professional Discipline Forums, the Shared Interest Forums will be hosting scientific sessions during the following times.

Shared Interest Forums

BEHAVIORAL AND PSYCHOLOGICAL SYMPTOMS OF DEMENTIA (BPSD)

Thursday, 8 September

13:15 – 14:45

Continental Ballroom 7-8

LONG TERM CARE

Wednesday, 7 September

10:00 – 11:30

Continental Ballroom 7-8

YOUNG ONSET DEMENTIA

Thursday, 8 September

10:00 – 11:30

Continental Ballroom 1-2



SCIENTIFIC PROGRAM - Tuesday, 6 September

3RD INTERNATIONAL CONFERENCE ON CAPACITY: RISKY BUSINESS AND OTHER RIGHTS

08:30 – 17:00

Continental Ballroom 1-2

Chair: Carmelle Peisah, Australia

- 08:30 Opening and Welcome
Carmelle Peisah, Australia
- 08:35 – 09:15 Sex Panel: Capacity, Consent, Assent and Advance Sex Directives
Jay Luxenberg, United States; Carmelle Peisah, Australia; Marc Hankin, United States; Oluwatoyin Sorinmade, United Kingdom
- 09:15 – 10:00 The Capacity to Marry and the Gold-digger
Jane Casey, New Zealand
- 10:00 – 11:00 Determination of Capacity of Frail Elders to Make a Decision to Remain in a Potentially Dangerous Environment
Irena Ginsburg, Caren Gould, United States
- 11:00 – 11:15 Morning Break
- 11:15 – 12:15 Assessing Decisional Capacity and Vulnerability to Undue Influence
James Spar, United States
- 12:15 – 13:00 Lunch
- 13:00 – 14:00 Mock Trial
Moderator-Chair: Renee Binder, United States
Sanford Finkel; Elliott Stein; Jay Luxenberg; Alex Obolsky, United States
- 14:00 – 15:00 The Ultimate Decision – Life and Death
Stephen Read, United States
- 15:00 – 15:30 Working Afternoon Break – Annual Meeting of Capacity Taskforce Shared Interest Group
- 15:30 – 16:30 TBC Risky Business from a Lawyer’s Perspective
Marc Hankin, United States
- 16:30 – 17:00 Capacity and Ageing Doctors
Carmelle Peisah, Australia
- Commentary from US Perspective
Betsy Williams, United States

IMAGING AND BIOMARKERS WORKSHOP

8:30 – 16:30

Continental Ballroom 7-8

Chairs: Gary Small, Canada; Michael Weiner, United States

- 08:30 – 09:15 Introduction, Objectives, Overview of Imaging and other Biomarkers in Psychogeriatrics
Gary Small, United States
- 09:15 – 10:05 FDG-PET Imaging in Dementia
Dan Silverman, United States
- 10:05 – 10:20 Break
- 10:20 – 11:10 Structural Imaging for Clinical and Research Settings
Cyrus Raji, United States
- 11:10 – 12:00 Imaging and Response to ECT
Katherine Narr, United States
- 12:00 – 13:00 Break for Lunch
- 13:00 – 13:50 Alzheimer’s Disease Neuroimaging Initiative (ADNI) Update
Michael Weiner, United States
- 13:50 – 14:40 Molecular Imaging in Neurodegeneration
William Jagust, United States
- 14:40 – 14:50 Break
- 14:50 – 15:40 Functional MRI and Cognition
Mark D’Esposito, United States
- 15:40 – 16:30 Biomarkers for Diagnosis
Doug Galasko, United States

SCIENTIFIC PROGRAM - Tuesday, 6 September

HOW TO CONDUCT CLINICAL TRIALS IN GERIATRIC PSYCHIATRY: EVERYTHING YOU WANTED TO KNOW ABOUT GERIATRIC CLINICAL TRIALS AND WERE AFRAID TO ASK

09:00 – 16:30

Continental Ballroom 3

Chairs: Mary Sano, United States; Olga Brawman-Mintzer, United States

09:30 – 10:00 Clinical Trial Practice Models: Advantages and Risks
to Consider

10:00 – 10:45 Building the team to do research within a clinical
practice
Mary Sano, United States

10:45 – 11:15 Is this protocol right for me
Olga Brawman-Mintzer, United States

11:30 – 12:00 Regulatory Knowledge
Joan Mackell, United States

13:00 – 13:30 Regulatory Knowledge – Part Two
Joan Mackell, United States

13:30 – 14:15 How to recruit subjects
Mary Sano, United States

14:15 – 15:00 Financial aspects: How will I pay the bills
Olga Brawman-Mintzer, United States

15:15 – 16:00 Panel Discussion: Topics in Geriatric Trials
*Mary Sano; Olga Brawman Mintzer; Joan Mackell;
Lon Schneider*

WORLD HEALTH ORGANIZATION (WHO) SESSION

15:30 – 17:00

Continental Ballroom 5

OPENING SESSION AND KEYNOTE LECTURE

17:00 – 19:00

Continental Ballroom 5

Welcome

Raimundo Mateos, IPA President

Helen Lavretsky and Lon Schneider, Congress Co-Chairs

President's Address

Raimundo Mateos, IPA President

Awards

Raimundo Mateos, IPA President

Keynote Lecture

Progress in Global Mental Health for Elders

Victor Valcour, United States

Public Health Response to Dementia

Tarun Dua, Switzerland

OPENING RECEPTION

19:00 – 20:30

Golden Gate Ballroom

We invite all registered delegates, guests, and speakers to a welcome reception after the opening session and keynote lectures. Attendance to this function is included in the registration fee.



SCIENTIFIC PROGRAM - Wednesday, 7 September

Plenary I: Dementia: Strategies for Success

Sube Banerjee, United Kingdom

08:30 – 09:30

Continental Ballroom 5

CONCURRENT SCIENTIFIC SESSIONS

10:00 – 11:30

SYMPOSIUM 1: INTERNATIONAL PSYCHOGERIATRICS' PAPERS OF THE MONTH: CLASS OF 2015 OR WHERE DO KNOWLEDGE ADVANCES LEAD US NEXT?

Continental Ballroom 1-2

- Psychotic symptoms in frontotemporal dementia: a diagnostic dilemma?
Maria Landqvist Waldö, Sweden
- Prevalence and incidence of dementia among indigenous populations: a systematic review
Laura A. Warren, Toronto
- Dementia and intentional and unintentional poisoning in older people: a 10 year review of hospitalization records in New South Wales, Australia
Brian Draper, Australia
- A comparison of delirium diagnosis in elderly medical inpatients using the CAM, DRS-R98, DSM-IV and DSM-5 criteria
Dimitrios Adamis, Ireland

SYMPOSIUM 2: IPA MEMBER FORUM (LONG TERM CARE): TEACHING NURSING HOMES AROUND THE GLOBE: CURRENT STATE AND FUTURE OPPORTUNITIES

Continental Ballroom 7-8

- The Development of Academic Nursing homes in the Netherlands
Raymond Koopmans, The Netherlands
- Teaching and Research Aged Care Services in Australia: Wicking Teaching Aged Care Facilities Program
David Conn, Canada
- Centres for Learning, Research and Innovation in Long-Term Care in Ontario, Canada
David Conn, Canada

FREE/ORAL COMMUNICATION 1: DEMENTIA AND BPSD

Continental Ballroom 3

- Epidemiological Transition in Dementia: Supporting Evidences from ASIADEMP collaborative study
Guk-Hee Suh
- The feasibility of investigating social connections and relationships to reduce BPSD in care homes
Janet Mitchell, Lynn Chenoweth, Janet Long, Jeffrey Braithwaite, Henry Brodaty

- Time for Dementia: development and evaluation of a novel inter-professional educational programme for medical and nursing students
Sube Banerjee
- Mild Behavioral Impairment (MBI): A pre-dementia syndrome linking neuropsychiatric symptoms and cognitive decline
Zahinoor Ismail, Henry Brodaty, Alicja Cieslak, Corinne Elenor Fischer, Serge Gauthier, Yonas E. Geda, Nathan Herrmann, Krista Lancot, David Miller, Moyra Mortby, Chiadi Uchendu Onyike, Luis F. Aguera-Ortiz, Paul Rosenberg, Eric Smith, Constantine Lyketsos
- Prognosis in Alzheimer's disease and mild cognitive impairment with comorbid Depression (PADR cohort)
Maria Lage Barca, Jurate Šaltyte Benth, Karin E. Persson, Rannveig Eldholm, Anne-Brita Knapskog, Geir Selbaek, Knut Engedal
- Clinical Support for Advancement of the RAGE Antagonist Azeliragon into Phase 3 Clinical Investigation for Mild Alzheimer's Disease
Aaron Burstein, Marwan Sabbagh, Mary Sano, Lon Schneider, Douglas Roger Galasko, Larry Altstiel

SYMPOSIUM 3: PSYCHOLOGICAL AND NEUROBIOLOGICAL FACTORS ASSOCIATED WITH COGNITIVE PERFORMANCE AND NEURODEGENERATIVE DISORDERS: IMPORTANCE FOR EARLY DIAGNOSIS AND TREATMENT

Continental Ballroom 5

- Neurocognitive Profiles of Late-life Anxiety and Depressive Symptoms
Sherry A. Beaudreau, United States
- Obsessive-compulsive disorders in aging brain-symptoms, comorbidity or risk for neurodegenerative diseases. Diagnostic challenge, role of biomarkers and benefit of early interventions
Kasia G. Rothenberg, United States
- Chromosomal instability in aging and in neurodegeneration
Kazimierz Gasiorowski, Poland
- Neurobiological links between major depression and Alzheimer's disease in older adults
Breno S. Diniz, United States
- Nanotechnology-based drug delivery systems in Alzheimer's disease-anti-Beta-amyloid and anti-inflammatory efficacy of dendrimers
Jerzy Leszek, Poland

CONCURRENT SCIENTIFIC SESSIONS

13:15 – 14:45

SYMPOSIUM 4: LATE-LIFE SUICIDAL BEHAVIOR AND SUICIDE: WHERE ARE WE AND WHERE DO WE NEED TO BE?

Continental Ballroom 1-2

- Epidemiology of Late-Life Suicidality: Prevalence, Risk Factors, and Important Research Issues to Consider
Amy Byers, United States
- Late-Life Suicidal Behavior and the Potential Role of Cognitive Impairment
John Kasckow, United States

SCIENTIFIC PROGRAM - Wednesday, 7 September

- Intervening on Suicidal Ideation: What We Have Learned from PROSPECT and Other Studies
Martha Bruce, United States
- Preventing Suicide in Older Adults: Innovative Treatments
Craig Nelson, United States

SYMPOSIUM 5: IPA JUNIOR RESEARCH AWARDS

Continental Ballroom 7-8

- Multi-modal MRI investigation of volumetric and microstructural changes in the hippocampus and its subfields in mild cognitive impairment, Alzheimer's disease, and dementia with Lewy bodies
Elijah Mak, United Kingdom
- A randomized controlled trial of Kundalini yoga in mild cognitive impairment
Harris Eyre, Australia
- Proxy rated quality of life of care home residents with dementia: A systematic review
Sarah Robertson, United Kingdom

FREE/ORAL COMMUNICATION 2: TREATMENT AND BPSD

Continental Ballroom 3

- Deciding on the treatment for challenging behaviors in patients with dementia
Sarah Janus, Janine Van Til, Jeannette Van Manen, Sytse Zuidema, Maarten IJzerman
- Impact of Temperature and Humidity on Agitation of Nursing Home Residents with Dementia
Federico Tartarini, Paul Cooper, Richard Fleming
- Extreme aggression in nursing home residents with dementia: a part of the WAALBED III study
Annelies Veldwijk-Rouwenhorst, Raymond Koopmans, Sytse Zuidema, Martin Smalbrugge, Roland Wetzels, Hans Bor
- The effect of six-monthly medication reviews on the appropriateness of psychotropic drug use for neuropsychiatric symptoms in patients with dementia: a randomized controlled trial
Klaas Van Der Spek, Raymond T. Koopmans, Martin Smalbrugge, Marjorie HJMG Nelissen-Vrancken, Roland Wetzels, Claudia HW Smeets, Sytse Zuidema, Debby Gerritsen
- Whole-body cryotherapy in memory deficits – modulatory effect on clinical and immunology variables
Joanna Rymaszewska, Elzbieta Trypka, Dorota Szczesniak, Katarzyna Urbanska, Bartlomiej Stanczykiewicz, Izabela Kokot, Sylwia Placzkowska, Lilla Pawlik-Sobecka, Agnieszka Zablocka
- Educational program improves staff competence and reduces BPSD in nursing home residents
Astrid Liv Mina Bergem, Nikias Siafarikas, Torill H. Andersson

SYMPOSIUM 6: SEVERE BEHAVIOUR RESPONSE TEAMS – ADDRESSING THE UNIQUE NEEDS OF INDIVIDUALS WITH VERY SEVERE BPSD, THROUGH A PERSON-CENTRED BIOPSYCHOSOCIAL PERSPECTIVE

Continental Ballroom 5

The Severe Behaviour Response Teams (SBRT) commenced national operations across Australia in November 2015 led by HammondCare. Key components of the service, believed to be the first of its type in the world, include rapid and responsive in reach to residential aged care facilities, and an emphasis on expert behavioural (rather than primarily pharmacological) management. The session will cover 3 themes – the experience and response of supporting people with very severe BPSD internationally; the Australian response to BPSD (from Dementia Behaviour Management Advisory Services to Severe Behaviour Response Teams); the first 12 months of implementation, lessons learned and results.

Speaker: Marie Alford, Australia

CONCURRENT SCIENTIFIC SESSIONS

15:15 – 16:45

FREE/ORAL COMMUNICATION 3: TREATMENT AND BIOLOGICAL MARKERS OF TREATMENT RESPONSE

Continental Ballroom 1-2

- Vilazodone inhibits pro-inflammatory gene expression and immunologic activation in geriatric depression
Helen Lavretsky
- Impact of sedative reduction, via a multifaceted intervention, on long-term care facility residents
Daniel J. Hoyle, Juanita Louise Westbury, Ivan Bindoff, Lisa Clinick, Gregory Peterson
- Atypical Antipsychotics as Add-on Treatment in Late Life Depression
Sibel Cakir, Zeynep Senkal
- The prevalence and cognitive correlates of drugs with potential risk of dementia
Hege Kersten

FREE/ORAL COMMUNICATION 4: CAREGIVER ISSUES

Continental Ballroom 7-8

- Final outcomes of the 'RedUSE' expansion: a national multi-strategic, interdisciplinary initiative aimed at reducing antipsychotic and benzodiazepine use in Australian Long Term Care Homes
Juanita Louise Westbury, Peter Gee, Tristan Ling, Gregory Peterson
- What education do aged care nursing staff want around the therapeutic management of older persons' mental health?
Juanita Louise Westbury, Donnamay Brown
- Relationship quality and distress in spouses of persons with dementia
Heidi Bjørge, Kari Kvaal, Ingun Ulstein
- Caregiver burden in hospitalized patients with late life depression
Ingun Ulstein, Maria Korsnes



SCIENTIFIC PROGRAM - Wednesday, 7 September

- Medically Unexplained Symptoms in later life: a link with physical frailty
Martje M. Grootaarts, Denise Hanssen, Richard Christiaan Oude Voshaar

SYMPOSIUM 7: DEMENTIA CHALLENGES AND SOLUTION FOR THE MIDDLE EAST

Continental Ballroom 3

- The Dementia Challenge in the Middle East: An opportunity for collaborative solutions
George Tadros, United Kingdom
- Diagnostic Challenges in the Middle East: Clinical and Cognitive assessment tools for Arabic Speaking countries
Osama Refaat Elsayed, Egypt
- Population based approach to developing culturally appropriate care pathways
Noha Sabry, Egypt

SYMPOSIUM 8: RECENT PROGRESS IN IMAGING AND NEUROPATHOLOGY IN DEMENTIA WITH LEWY BODIES

Continental Ballroom 5

- Inter-relationship of the neuropathologies of Alzheimer's disease and Lewy body disease in the context of DLB
Pietro Tiraboschi, Italy
- Recent data from the Italian SCILLA study comparing the utility of MIBG cardiac and FP-CIT striatal imaging in the differential diagnosis of DLB from other causes of dementia
Cristina Muscio, Italy
- FP-CIT Imaging and DSM-5 Diagnosis in Mild Neurocognitive Disorder
Paul Donaghy, United Kingdom
- Autopsy Validation of FP-CIT Imaging in DLB
Alan Thomas, United Kingdom

Plenary II: Positive Psychiatry

Dilip Jeste, United States

17:00 – 18:00

Continental Ballroom 5

IPA Members Annual Business Meeting

18:00 – 18:30

Continental Ballroom 5

SCIENTIFIC PROGRAM - Thursday, 8 September

Plenary III:

Olusegun Baiyewu, Nigeria

Cleusa Ferri, Brazil

Mental Health Care for Older Adults in South America

08:30 – 09:30

Continental Ballroom 5

CONCURRENT SCIENTIFIC SESSIONS

10:00 – 11:30

SYMPOSIUM 9: IPA MEMBER FORUM (YOUNG-ONSET DEMENTIA): YOUNG-ONSET FRONTOTEMPORAL DEMENTIA — THE CHALLENGES FOR FAMILIES OF A DISTINCTIVE DIAGNOSIS

Continental Ballroom 1-2

- The prevalence and the diagnostic work-up and the general awareness of FTD with debut in younger age
Howard Rosen, United States
- Consequences of Young-onset Dementia on daily living and important predictors of quality of life – Results from a European Multi-center Assessment
Lara Hvidsten, Norway; Joany Millenaar, The Netherlands
- Living with a diagnosis of behavioural-variant frontotemporal dementia: The person's experience
Jan R. Oyebode, United Kingdom
- Experiences and needs for assistance among spouses of people with young-onset frontotemporal dementia: A qualitative study
Aud Johannessen, Norway

SYMPOSIUM 10: INNOVATIONS IN GERIATRIC PSYCHIATRY FOCUSING ON SIMULATION, PUBLIC EDUCATION, PHYSICIAN HEALTH, AND ONLINE EDUCATION (CAGP SYMPOSIUM)

Continental Ballroom 7-8

- Innovations in Geriatric Psychiatry Education: Blending Online, Didactic, and Skills-based Approaches
Mark Rapoport, Canada
- Teaching Electroconvulsive Therapy Skills using Simulation: A New Standard for Credentialing
Kiran Rabheru, Canada
- Teaching an Old 'doc' New Tricks: Burnout and Coping with Changes to the Health Care System
Shabbir Amanullah, Canada

FREE/ORAL COMMUNICATION 5: TRAINING ISSUES IN DEMENTIA CARE

Continental Ballroom 3

- Development of a Global Dementia Resource Website for Patients and Families
David K. Conn, Bilal Yousuf, Kelsey Yarlett
- The Model of "CPT" Cultural Pedagogical Theatre to Apply in Social and Sanitary Professionals Training
Imma Miralles Garcia, Esso Petersson

- Videoconsultation is a Feasible and Valid Alternative of Providing Psychiatric Care to the Nursing Home
Raimundo Mateos, Ramón Ramos, David Lojo, Tim Patterson, David K. Conn
- Sleep Disorders and Risk of Dementia in Late Life: 13-Year Longitudinal Study of Healthcare Members
Jason Flatt, Charles Quesenberry, Jennifer Liu, Kathleen Albers, Rachel Whitmer
- The conditions of prescribing of antipsychotic medications in residential aged care: the HALT project
Fleur Harrison, Monica Cations, Tiffany Jessop, Allan Shell, Lynn Chenoweth, Henry Brodaty

SYMPOSIUM 11: MAGNETIC SEIZURE THERAPY AND NEW FINDINGS IN THE CLINICAL PRACTICE OF ELECTROCONVULSIVE THERAPY IN THE ELDERLY

Continental Ballroom 5

- The use of ECT in neurological disorders in the geriatric population
Adriana Hermida, United States
- Historical Overview and latest theories of the mechanisms of action of ECT
George Petrides, United States
- The PRIDE Study: Efficacy Results
Charles H. Kellner, United States
- Magnetic Seizure Therapy
Mustafa Husain, United States

S12: THE ART OF BECOMING A LEADER IN GERIATRIC PSYCHIATRY: LEARN FROM THE EXPERTS

Continental Ballroom 9

This session is an interactive workshop that provides a unique leadership training opportunity by two prominent leaders: Dr. Luanne Thorndyke, MD, Vice Provost of Faculty Affairs at the University of Massachusetts Medical School and immediate past Chair of the American Association of Medical Colleges Group on Faculty Affairs, and Dr. Tatyana Shteinlukht, MD, PhD, Director of ECT service in the Department of Psychiatry, University of Massachusetts Medical School.

Speaker: Tatyana Shteinlukht, United States

CONCURRENT SCIENTIFIC SESSIONS

13:15 – 14:45

SYMPOSIUM 13: RISK FACTORS AND BIOMARKERS FOR NEURODEGENERATION (AAGP SYMPOSIUM)

Continental Ballroom 1-2

- [F18]FDDNP-PET Brain Binding Patterns in Military Personnel with Suspected Chronic Traumatic Encephalopathy
Gary Small, United States
- Olfactory Identification Deficits, Cognitive Decline and Alzheimer's Disease
Davangere P. Devanand, United States



SCIENTIFIC PROGRAM - Thursday, 8 September

- Amyloid-B, Neuropsychiatric Symptoms and the Risk of Incident Mild Cognitive Impairment: The Mayo Clinic Study of Aging
Janina Krell-Roesch, United States

SYMPOSIUM 14: IPA MEMBER FORUM (BPSD SHARED INTEREST): CRISIS IN PATIENTS WITH EXTREME BPSD

Continental Ballroom 7-8

- A seven-tiered model on BPSD
Brian Draper, Australia
- TIME — Targeted Interdisciplinary Model for Evaluation and Treatment of Neuropsychiatric Symptoms
Sverre Bergh, Norway
- Waalbed-III study, determinants of extreme agitation and factors leading to a crisis
Debby Gerritsen, The Netherlands
- How to manage a patient with a BPSD crisis: diagnosis and treatment for the BPSD-patient bringing dignity to the patient and to the caregivers
Inger-Marie Tjernaes, Norway

FREE/ORAL COMMUNICATION 6: DEMENTIA & ALZHEIMER'S DISEASE

Continental Ballroom 3

- Subjective experience of people with Alzheimer's disease participating in the physical activity trial Fitness for the Ageing Brain Study II (FABS II)
Nicola Lautenschlager, Osvaldo Almeida, Leon Flicker, Elizabeth Cyarto, Dina Logiudice, Keith Hill, David Ames, Christopher Ethern-beer, Gerard Byrne, Kana Appadurai, Kay Cox
- Common variations at CLU are associated with lipid levels in Alzheimer's disease
Lu Hua Chen
- Detecting changes in computer-use behaviours as an indicator of early cognitive decline: a feasibility study
Samuel Couth, Gemma Stringer, Ann Geldson, Joseph Mellor, Iracema Leroi
- A Norwegian twin study of heritability and environmental factors in Alzheimer's disease and other dementias
Astrid Liv Mina Bergem, Nikias Siafarikas, Thomas S. Nilsen, Per Magnus, Tor Atle Rosness, Bjørn H. Strand, Henrik Schirmer, Gunn P. Knutsen, Knut Engedal, Espen Bjertness
- Past, Present and Future of The 10/66 Dementia Research Group
Daisy Miguelina Acosta
- Role of Apathy in Functional Decline in Alzheimer's Disease
Hillel Grossman, Carolyn Zhu, Mary Sano

FREE/ORAL COMMUNICATION 7: DEMENTIA - MILD COGNITIVE IMPAIRMENT

Continental Ballroom 5

- Subjective Memory Complaint and Objective Memory Performance: Moderating Effect of Cognitive Impairment
Ah-Rong Lee, Ji-Hye Lee, Soowon Park, Yongjoon Yoo, Jung-Hae Youn, Seung-Ho Ryu, Jun-Young Lee, Seong Jin Cho
- The Detection, Diagnosis and Impact of Cognitive Impairment Amongst Over 65s admitted to an Irish University-Affiliated, Tertiary-Referral Hospital
Clodagh Power, Helena Bates, Mike Healy, Elaine Greene
- History of Traumatic Brain Injury and APOE are Uniquely Associated with Cognitive Impairment and Dementia in the Aging, Demographics, and Memory Study (ADAMS)
Nicholas T. Bott, Nathan Hantke, Victoria Liou-Johnson, Sherry A. Beaudreau
- The Neuropsychological Profile of Remote Traumatic Brain Injury in Older Veterans
Allison R. Kaup, Carrie Peltz, Kimbra Kenney, Joel H. Kramer, Ramon Diaz Arrastia, Kristine Yaffe
- The operationalization of mild cognitive impairment for dementia prediction: less is more
Henry Brodaty, Liesbeth Aerts, John D. Crawford, Megan Heffernan, Nicole Kochan, Simone Reppermund, Kristan Kang, Kate Maston, Brian Draper, Julian Trollor, Perminder Sachdev
- Measuring computer use behaviours to detect cognitive and functional impairment in early dementia
Gemma Stringer, Samuel Couth, Laura Brown, Daniela Montaldi, Ann Geldson, Joseph Mellor, Iracema Leroi

SYMPOSIUM 15: THE DEPRESSED-FRAIL PHENOTYPE; A SUBTYPE OF LATE-LIFE DEPRESSION THAT CALLS FOR ACTION!

Continental Ballroom 9

- Frailty, a neglected geriatric syndrome in the treatment of late-life depression
Richard C. Oude Voshaar, The Netherlands
- The Depressed-Frail Phenotype: a role for metabolic dysregulation?
Radboud M. Marijnissen, The Netherlands
- The Depressed-Frail Phenotype: Results from the Health ABC study
Patrick J. Brown, United States
- The Depressed-Frail Phenotype: Results from a clinical cohort of depressed older patients
Matheus H.L. Arts, The Netherlands

Plenary IV:

Miia Kivipelto, Sweden

Dementia Prevention among at Risk Persons

Edo Richard, The Netherlands

Dementia Prevention from a Population Perspective

15:15 – 16:15

Continental Ballroom 5

SCIENTIFIC PROGRAM - Friday, 9 September

Plenary V: Prevention of Late-Life Depression & Anxiety in Low & Middle Income Countries: An Intervention Development Project (DIL)

Charles Reynolds, III, United States

08:30 – 09:30

Continental Ballroom 5

CONCURRENT SCIENTIFIC SESSIONS

10:00 AM – 11:30 AM

FREE/ORAL COMMUNICATION 8: DEMENTIA-YOUNG ONSET

Continental Ballroom 1-2

- What is the contribution of potentially modifiable environmental and lifestyle risk factors to young onset dementia? Preliminary results from the INSPIRED study
Monica Cations, Adrienne Withall, Fiona White, Julian Trollor, Clement Loy, Henry Brodaty, Perminder Sachdev, Peter Gonski, Apo Demirkol, Robert G. Cumming, Lee-Fay Low, Brian Draper
- Why aren't people with young onset dementia and their caregivers using formal services?
Monica Cations, Adrienne Withall, Fiona White, Julian Trollor, Clement Loy, Henry Brodaty, Perminder Sachdev, Peter Gonski, Apo Demirkol, Robert G. Cumming, Lee-Fay Low, Brian Draper
- The course of cognitive functioning and dementia severity in Young-Onset dementia
Adrie Gerritsen, Christian Bakker, Frans R.J. Verhey, Marjolein De Vugt, Raymond T. Koopmans
- HIV associated neurocognitive disorders and relation to CD4 count among patients at Mildmay Uganda
Noeline Nakasujja, Harriet Chemusto, Yvonne Karamagi, Mary Odiit, Dan Kajungu, Charity Kyomugisha-Nuwagaba, Barbara Mukasa, Seggane Musisi, Christina Lindan
- Assessing dementia risk in general practice: a qualitative study of the attitudes and views of members of the public
Lisa A. Newton, Claire Dickinson, Louise Robinson
- Can be hypothyroidism considered reversible dementia?
Sarah Domingues Calixto, Daniela Suzuki Locatelli, Marcos O. Martinelli, Jose Eduardo Martinelli

FREE/ORAL COMMUNICATION 9: LATE-LIFE NEUROPSYCHIATRIC DISORDERS 1

Continental Ballroom 7-8

- Improving Diagnostics Beyond the DSM-5: a Proof-of-Principle Study Using Personalized Feedback on Daily Dynamics of Psychopathology
Date C. Van Der Veen, Renske Kroeze, Harriette Riese, Michelle N. Servaas, Jojanneke A. Bastiaansen, Richard Christiaan Oude Voshaar, Denny Borsboom, Henricus G. Ruhe, Robert A. Schoevers
- Anxiety in late-life depression: results of a longitudinal cohort study
Date C. Van Der Veen, Hannie C. Comijs, Robert A. Schoevers, Willeke Van Zelst, Richard Christiaan Oude Voshaar

- Autism in the elderly: Towards appropriate care
Shabbir Amanullah
- Clinical and Cognitive Outcome, Course of Late Onset Depression - A Study from Geriatric Services of a Tertiary Care Center in India
Sridatta Rajur, Mathew Varghese, Sivakumar Palanimuthu Thangaraju, Keshav Kumar
- Common mental disorders and mortality among older adults living in low and middle income countries: a 10/66 study
Matthew Prina, Carolina Kralj, Mariella Guerra, Daisy Miguelina Acosta, Cleusa Ferri, Martin James Prince
- Cognitive Outcomes in the Ageing Cannabis User
Adrienne Withall, Nicholas Lintzeris, Lauren Monds, Brian Draper, Nicole Ridley, Raimundo Bruno, David Allsop

FREE/ORAL COMMUNICATION 10: LATE LIFE NEUROPSYCHIATRIC DISORDERS 2

Continental Ballroom 3

- The Impact of Function Focused Care on Physical Function, Activity, and Behavior of Nursing Home Residents with Dementia
Elizabeth Galik, Barbara Resnick
- Dysfunctional Beliefs and Attitudes about Sleep among Elderly Pensioners with Insomnia in Abeokuta, Nigeria
Adefolakemi Temitopee Ogundele, Ighoroje Maroh
- Psychotropic medication use in Australian Long Term Care Homes
Juanita Louise Westbury, Peter Gee, Tristan Ling, Gregory Peterson, Donnamay Brown

SYMPOSIUM 16: PROGRAM OF ALL-INCLUSIVE CARE FOR THE ELDERLY FOR CHINESE IMMIGRANT POPULATION: AN ALTERNATIVE MODEL FOR KEEPING ELDERLY AT HOME

Continental Ballroom 5

Speakers: Jay Luxenberg, Benjamin Kao, Dandan Liu, United States

CONCURRENT SCIENTIFIC SESSIONS

13:15 – 14:45

FREE/ORAL COMMUNICATION 11: LONG TERM CARE

Continental Ballroom 1-2

- Joint effort key in successful implementation
Erica De Vries, Claudia HW Smeets, Martin Smalbrugge, Klaas Van Der Spek, Sytse Zuidema, Raymond T. Koopmans, Debby Gerritsen
- The Ageing Prisoner: A Rapidly Growing International Issue
Adrienne Withall, Nikola Ninaus, Jo-Ann Brown, Peter Schofield, Henry Brodaty, Tony Butler



SCIENTIFIC PROGRAM - Friday, 9 September

FREE/ORAL COMMUNICATION 12: LATE-LIFE NEUROPSYCHIATRIC DISORDERS 3

Continental Ballroom 7-8

- Diagnosis and Management of Neurogenic Orthostatic Hypotension
Adam Ziemann, Sandra Mertz, Gerald Rowse, Beverly Karabin
- The introduction of a tailored psycho-educational tool to engage groups at risk of developing dementia
Sandra Evans, Genevieve Holt
- Onset of Psychiatric Disorders in Patients with Parkinson's Disease
Andreea Seritan, Jill Ostrem
- Diagnosis and current treatment of common neuropsychiatric manifestation of Parkinson's Disease
Adriana Hermida
- The association between psychosis and anxiety in Parkinson's Disease and the occurrence of cognitive dysfunction
Felicia Goldstein

SYMPOSIUM 17: DEPRESSION AND COGNITION ACROSS BOUNDARIES: WHAT CAN WE LEARN FROM EPIDEMIOLOGICAL STUDIES?

Continental Ballroom 3

- The relationship between depression and cognition across countries: findings from the 10/66 study
Matthew Prina, United Kingdom
- Late-life depression dimensions and cognitive functioning in the Longitudinal Aging Study Amsterdam: A cross-domain latent growth curve analysis
Anamaria Brailean, United Kingdom

SYMPOSIUM 18: INNOVATIVE APPROACHES TO MODELING GERIATRIC MENTAL HEALTH DATA

Continental Ballroom 5

- Latent group-based trajectory modeling of depression and cognitive function
Joanne C. Beer, United States
- Statistical analyses addressing competing risks in Alzheimer Disease research
Tianxiu Wang, United States
- Modeling the non-linear effects of blood pressure on longitudinal cognitive performance in elderly: perspectives and tools
Zhaowen Sun, United States
- Estimation of the effects of brain regional volumes on cognitive state accounting for sampling biases
Chung-Chou H. Chang, United States

CONCURRENT SCIENTIFIC SESSIONS

15:15 – 16:45

FREE/ORAL COMMUNICATION 13: SUICIDE AND OTHER LATE-LIFE NEUROPSYCHIATRIC DISORDERS

Continental Ballroom 1-2

- Suicide Risk Assessment Decision Aid in Long Term Care Settings
Mark Herbert Lachmann
- Gender differences in co-morbid physical and mental disorders as predictors of suicide in older adults
Helen-Maria Vasiliadis, Samantha Gontijo Guerra, Catherine Lamoureux-Lamarche
- Self-harm and Dementia
Brian Draper, Rebecca Mitchell, Lara Harvey, Henry Brodaty, Jacqui Close
- Worthlessness Uniquely Predicts Future Anxiety Symptom Severity in Community-Dwelling Older Adults
Nehjla Masha, Sherry A. Beaudreau

FREE/ORAL COMMUNICATION 14: THERAPY & TREATMENT (NON-PHARMACOLOGICAL)

Continental Ballroom 7-8

- Psychodynamic Psychotherapy for Older Adults
Neil Raveen Jeyasingam
- Preliminary results of multidisciplinary group therapy for older adults
Silvia Diane Van Dijk, Richard Christiaan Oude Voshaar
- Resonant circuits are potential confounding factors of electroconvulsive therapy (ECT) in elderly patients
Andreas Raether, Karin Gita Ademmer
- Improving the mental health of caregivers of people with dementia
Denise Ann Wissmann
- The potential of mindfulness-based interventions to prevent memory decline as well as hippocampal and entorhinal atrophy in older adults with mild cognitive impairment: Preliminary findings
Eddy Larouche, Anne-Marie Chouinard, Sonia Goulet, Simon Duchesne, Carol Hudon

SYMPOSIUM 19: DIAGNOSIS AND MANAGEMENT OF COGNITIVE COMPLAINTS IN THE COGNITIVELY NORMAL OLDER ADULT PATIENT

Continental Ballroom 3

- All That Forgets is not Dementia: Understanding the Patient with Conversion Disorder with Cognitive Features
Steven Huege, United States
- Neuropsychological Testing Profiles of Patients with Non-neurodegenerative Based Cognitive Complaints
Kathleen Breslin, United States
- Addressing the Social Needs of Patients with Conversion Disorder with Cognitive Symptoms
Anna Van Dien, United States

SCIENTIFIC PROGRAM - Friday, 9 September

SYMPOSIUM 20: PERSON CENTRED CARE FOR PERSONS WITH DEMENTIA – EFFECT, UNDERSTANDING AND IMPLEMENTATION – CHALLENGES AND POSSIBILITIES FROM NURSES' PERSPECTIVE

Continental Ballroom 5

- Person-centred care: what it is and what it is not?
David Edvardsson, Sweden
- The effects of interventions aiming to implement person-centred dementia care in nursing homes
Anne Marie Mork Rokstad, Norway
- Overcoming challenges in implementing person-centred care
Janet Mitchell, Australia
- Is it possible to get «evidence» for the effect of person centred care?
Øyvind Kirkevold, Norway



SCIENTIFIC PROGRAM - POSTERS

POSTER SESSION 1

Wednesday, 7 September

11:30 – 13:00

Golden Gate Ballroom

- P1 Relationships between creativity and hobbies in the elderly
Carlo Cristini, Valentina R. Andolfi, Chiara Valenti, Giovanni Cesa-Bianchi, Alessandro Antonietti
- P2 Motivations and Meanings behind the Commencement of Activities: Qualitative Study among Local Elderly Residents
Shingo Yamane, Sae Tanaka, Hideaki Hanaoka
- P3 A Comprehensive Community Care model for Geriatric Population in a small rural Japanese community at Joetsu Suwa District
Yu Kawamuro
- P4 Analysis of Cambridge Cognitive Examination (CAMLOG) in Octogenarians and nonagenarians
Lucas Romano, Livia Galeote, Juliana F. Cecato, Isadora Z. Araujo, Barbara Stella, Jose Eduardo Martinelli
- P5 Main fears in old age
Giovanni Cesa-Bianchi, Carlo Cristini, Angela Solimeno-Cipriano, Luca Cristini, Alessandro Porro, Marcello Cesa-Bianchi
- P6 Are older adults with fall-related concerns more anxious in general? Results from a systematic review and meta-analysis
Marie-Christine Payette, Vanessa Léveillé, Claude Bélanger, Sebastien Grenier
- P7 Information-Seeking About Anxiety in Older Veterans: A Qualitative Investigation
Aimee Marie L. Zapata, Christina Garrison-Diehn, Sherry A. Beaudreau, Ruth O'Hara, Christine E. Gould
- P8 Development and Initial Feasibility of a DVD-Delivered Relaxation Treatment to Reduce Anxiety in Older Community-Dwelling Adults
Christine E. Gould, Ruth O'Hara, Vanessa K. Ma, Brian C. Kok, Julie Wetherell, Mary K. Goldstein, Sherry A. Beaudreau
- P9 Behavioral and psychological symptoms of dementia and antipsychotic drug use in the elderly with dementia in Korea long-term care facilities
Kang Soo Lee
- P10 Teleconsultation for Behavioral and Psychological Symptoms of Dementia (BPSD): increasing accessibility to geriatric psychiatry care in Quebec
Marie-Andrée Bruneau, Laurence Villeneuve, Carline Ménard
- P11 Music therapy decreases resistiveness to care and improve communication with caregivers
Marie-Andrée Bruneau, Ana Ines Ansaldo, Guy Banville, Suzanne Généreux, Micheline Hubert, Caroline Ménard, Laurence Villeneuve, Elisa Vauclare, Laurence Charest
- P12 De Clerambault's syndrome in dementia
Kuei-Yu Liang, Chun-Chi Ho
- P13 Severity and occurrence of behavioral and psychological symptoms among patients of different dementia stages in Taiwan
Si-Sheng Huang, Cheng-Chen Chang
- P14 PEACE-AD: An NIA Alzheimer's Disease Cooperative Study Multi-center Trail of Prazosin for Agitation in AD
Murray Raskind, Elaine Peskind
- P15 Aging effect of mitochondrial DNA copy number and increased oxidative damage in clinically stable patients with major depressive disorder
Cheng-Chen Chang, Ta-Tsung Lin, Chin-San Liu, Te-Jen Lai, Si-Sheng Huang
- P16 Translation, Cross-Cultural Adaptation of the Routine Task Inventory-Expanded (RTI-E) to Brazilian Portuguese: pre-test with elders
Particia Cotting Homem de Mello, Patricia Neubern, Adriane Torres Colozio, Natalie Torres Matos, Diego Celestino, Alexandra M. Oliveira, Noomi Katz, Tania C.T.F. Alves
- P17 Supporting family carers of people living with dementia: the development of a new mobile application
Sally Wai-chi Chan, Robert Sanson-Fisher, Amanda Wilson, Sharyn Hunter, Sarah Jeong, Kichu Nair, Viki Brummell, Frans Henskens
- P18 An Indo-Canadian Cross Cultural Qualitative Study on Caregivers of Persons with Dementia
Nadeesha L. Fernando, Murali Krishna, Ashok Krishnamoorthy, Caroline Fall, Kumaran Kalyanaraman, Paras Mehta, Sarah Stott-Eveneshen, Videsh Kappor
- P19 The Caregiver Literacy Series: An opportunity to educate caregivers about the biology behind Alzheimer's Disease and Dementia
Elaine Jurkowski
- P20 Mente Sana, Cuerpo Sano ("Healthy Brain, Healthy Mind"): A Spanish-language Community Based Program for Older Adult Mental Wellness
Andrew Neal Dentino, Maricela Buenfil, Maggie Darcey, Kelli Bruemmer, Sara Sherry, Roberto Medina, Julie Nelson
- P21 Morning type, mental illness, personality and quality of life in a Community Sample of Korean Elderly
Jae-Nam Bae, Seong-Jin Cho, Won-Hyoung Kim, Seung-Min Oh, Bong-Jin Hahm
- P22 Building Intraprofessional Collaboration for Mental Health Practice with Older Adults Through Problem Based Learning
Elaine Jurkowski, Sharon Smaga, Cherie Kelly, Ruth Heitkamp
- P23 Validation of Korean version of Delirium Motor Subtype Scale (K-DMSS)
Jeong Lan Kim, Miji Lee, Hyunkyung Kim
- P24 Emergency Department Use by Community-Dwelling Persons with Dementia: A Systematic Review
Lauren J. Hunt, Caroline E. Stephens

SCIENTIFIC PROGRAM - POSTERS

- P25 An educational program for nurses and caregivers incorporating a serious game to simulate care processes for elderly individuals with Alzheimer's disease in Japan
Miwa Yamamoto, Yasuko Maekawa, Tomoharu Nakashima, Yoko Miyoshi, Junko Yoshimura, Kiyoko Tokunaga
- P26 A Quick Test of Cognitive Speed: Detecting Alzheimer's Disease in Korean Elderly
Youngsung Cho, Suyeon Pyo, Soowon Park, Jun-Young Lee
- P27 Study on Cognitive Reserve Using Cognitive Reserve Index Questionnaire
Chi Hyun Choi, Jae Yeon Hwang, Soowon Park, Hyeon-Ju Park, Youngsung Cho, Bo Kyung Sohn, Jun-Young Lee, Kang-Seob Oh
- P28 Long-term culture of organotypic hippocampal slice of 3xTg Alzheimer's disease model mouse
Soo Ah Jang, Hyunjeong Kim, Su Kyoung Lee, Hyejin Kim, Eun Woo Kim, Kee Namkoong, Eosu Kim, Byung Hoon Oh
- P29 Quality of Life and depressive symptoms in Alzheimer disease
Patricia C. Buchain, Eron Luiz Santos, Carlos Eduardo Borges Marra, Regina Netto, Tania C.T.F. Alves
- P30 A Prospective Study on Change of Hippocampal Volume by the Occurrence of APOE e4 in Mild Cognitive Impairment (MCI)
Kee Baik Seok, Seok Woo Moon
- P31 Direct and Indirect evaluation of functionality in AD patients
Janaina Harder, Patricia C. Buchain, Tania C.T.F. Alves, Pamela Quiroga, Everton Duarte, Patricia Cotting Homem de Mello, Alexandra M. Oliveira
- P32 Apraxia evaluation in nonagenarian: data from an Ambulatory Geriatrics
Jose Eduardo Martinelli, Livia Galeote, Isadora Z. Araujo, Barbara Stella, Nicole Costa, Juliana F. Cecato
- P33 Lack of information about apraxia in Mini-mental State Exam: evaluating Alzheimer's disease
Juliana F. Cecato, Ivan Aprahamian, Livia Galeote, Isadora Z. Araujo, Barbara Stella, Nicole Costa, Jose Eduardo Martinelli
- P34 Development of a Virtual Reality-experience to improve compassion in caregivers of people with dementia
Marjolein Veerbeek, Bernadette Willemse, Marleen Prins, Anne Margriet Pot
- P35 Idalopirdine, a 5-HT6 antagonist in phase III development as adjunctive therapy to cholinesterase inhibitors in patients with mild-to-moderate Alzheimer's disease: the observed case analyses of the phase II study
Jeffrey Cummings, Kristian Windfeld, Tomas Odergren, Dan Michel
- P36 Synergistic effects of AB on a-synuclein-induced neurotoxicity and behavioral deficits in dementia with Lewy bodies (DLB)
Te-Jen Lai, Yen-Ying Chang, Hsin-Hua Li, Ching-Chi Chang, Ying-Jui Ho, Pai-Yi Chiu, Chih-Li Lin
- P37 Potential Treatments for Lewy Body Dementia Being Investigated in Three Randomized, Double-Blind, Placebo-Controlled Phase 2 Studies of Intepirdine and Nelotanserin
Lawrence Friedhoff, Ilise Lombardo, Warren Wren, Geetha Ramaswamy, Jason T. Olin
- P38 Comparison of Different Cognitive Function Scales for Screening the Mild Cognitive Impairment among the Older Taiwanese People
Jhan Yi Lin, Hui-Chuan Hsu, Jiun-Yi Wang
- P39 Extrapyramidal signs as a risk factor for progression from mild cognitive impairment to dementia: a CREDOS study
Jae Won Chung, Woojae Myung, Jinhong Park, Sook-young Woo, Myeong-Il Han, Seonwoo Kim, Sang Ha Kim, Hyo Shin Kang, Shinn-Won Lim, Junbae Choi, Duk L. Na, Seong Yoon Kim, Jae-Hong Lee, Bernard Carroll, Doh Kwan Kim
- P40 The Influence of Polypharmacy in Cognitive Decline for an Elderly Population: a Nationwide Population-Based Survey
Chih-Ming Cheng
- P41 Cognitive Impairment and Depressive Symptoms among Elderly Patients presenting with Fall injury in Orthopaedic clinics in South western Nigeria
Olusegun Baiyewu
- P42 Client experiences following a clinical diagnosis of mild cognitive impairment and cognitive disorder not otherwise specified
Alison McKinlay, Janet Leathem, Paul Merrick
- P43 Subjective cognitive impairment, mental health disorders and global cognitive functioning among older adults in primary care
Marie-Christine Payette, Lina Roy, Sebastien Grenier, Fethia Benyebdri
- P44 Relationship between Serum Homocysteine Level, Drinking and Partners of Dementia Patients
Jian-Kang Chao
- P45 A Quasi-Randomized Controlled Trial of Brain-Activating Rehabilitation in the Day Care Setting at an Acute Hospital
Kenji Tsuchiya, Tomoharu Yamaguchi, Takaaki Fujita, Maya Taguchi, Aoi Honda, Yuki Satou, Hiroshi Sekiguchi, Noriko Kimura, Tenshi Osawa, Masanori Terauchi
- P46 Prevalence of Mild Behavioral Impairment (MBI) in a Memory Clinic Population and the Impact on Caregiver Burden
Faisal S. Sheikh, Zahinoor Ismail, Philip Barber, Alicja Cieslak, Moyra E. Mortby, Karyn Fischer, Robert Granger, David Hogan, Aaron Mackie, Colleen Maxwell, Bijoy Menon, David Patry, Dawn Pearson, Jeremy Quickfall, Eric Smith
- P47 An abbreviated scale measuring social cognition in dementia syndromes
John D. Papatrianatafyllou, Vasiliki Kamtsadeli, Theodoros Parthymos, Evi Lykou, Maria Hatzopoulou, Tatianna Dimitriou-Kirchoff, Niki Tsinia, Sokratis Papageorgiou
- P48 Stigma kills! A case report of a Ugandan woman suffering from HIV; the psychological effects of emotional abuse and discrimination into old age
Simon Ruffell

SCIENTIFIC PROGRAM - POSTERS

- P62 Association between chief complaints and subsequent psychiatric diagnoses in Thai elderly
Tinakon Wongpakaran, Nahathai Wongpakaran, Peerasak Lerttrakarnnon, Surin Jiraniramai, Thanitha Siriruk, Sawitri Assanangkornchai, Unchulee Tameyapradit, Nopporn Tantirangsee, Surang Lertkachtharn, Suwanna Arunpongpaisal, Suwit Charoensak, Poonsri Rangseekajee
- P64 Role of neuroticism in the development of depressive symptoms among elderly patients with and without depression
Nahathai Wongpakaran, Tinakon Wongpakaran, Peerasak Lerttrakarnnon, Surin Jiraniramai, Thanitha Siriruk, Sawitri Assanangkornchai, Unchulee Tameyapradit, Nopporn Tantirangsee, Surang Lertkachtharn, Suwanna Arunpongpaisal, Suwit Charoensak, Poonsri Rangseekajee
- P65 Optimal Cut-Off Score for Defining Remission in Elderly with Depression using GRID-HAMD-7
Nahathai Wongpakaran, Tinakon Wongpakaran
- P66 Confirmatory Factor Analysis of the revised Thai Multidimensional Scale of Perceived social support (revised MSPSS) in Elderly with depression
Tinakon Wongpakaran, Nahathai Wongpakaran
- POSTER SESSION 2**
Thursday, 8 September
11:30 – 13:00
Golden Gate Ballroom
- P49 Reduced fronto-subcortical white matter connectivity in association with suicidal ideation in major depressive disorder
Ki Won Kim, Woojae Myung, Cheol E. Han, Maurizio Fava, David Mischoulon, George I. Papakostas, Jung-Yoon Heo, Sung Tae Kim, Doh Kwan Kim, Sang Won Seo, Joon-Kyung Seong, Hong Jin Jeon
- P50 Lifetime suicidal ideation and attempt in adults with full major depressive disorder versus sustained depressed mood only
Hye Jin Yoo, Jin Pyo Hong, Maeng Je Cho, Maurizio Fava, David Mischoulon, Jung-Yoon Heo, Ki Won Kim, Hong Jin Jeon
- P51 Cross-national differences in hypochondriasis symptoms between Korean and American outpatients with major depressive disorder
Ji Yeon Kim
- P52 Prevalence and predictors of late-life depression in Korea: Association of risk factors and cognitive function
Sung Man Chang, Seong Jin Cho, Jun-Young Lee
- P53 Association of depressive symptoms to nutritional status and habits in a sample of elderly from the community: a Brazilian cross-sectional study
Salma Rose Imanari Ribeiz, Lucas Bassolli, Clovis Alexandrino-Silva, Cassio Machado De Campos Bottino
- P54 Association of depressive symptoms to leisure activities in a sample of Brazilian elderly from the community: a cross-sectional study
Cassio Machado De Campos Bottino, Clovis Alexandrino-Silva, Lucas Bassolli, Salma Rose Imanari Ribeiz
- P55 Depressive symptoms among Chinese older adults treated in primary care: an epidemiological survey
Helen Fung-Kim Chiu
- P56 Bayesian analyses showed more evidence for apathy than for depression being associated with cognitive functioning in nursing homes
Ruslan Leontjevas, Lily Fredrix, Martin Smalbrugge, Raymond T.C.M. Koopmans, Debby Gerritsen
- P57 Association among Depressive Symptoms, Physical Activity and Use of Substances in Community-Dwelling Older Adults: Results of the “Prevention and Treatment of Depression in Elderly” Study, Brazil
Clovis Alexandrino-Silva, Maria Beatriz Frigerio, Salma Ribeiz, Lucas Bassolli, Cassio Machado De Campos Bottino
- P58 Effects of Social Support on Treatment Response in Late Life Depression
Yiu Ho Au, David Bickford, Krista Farley, Kelly B. Scherer, Roksana Sadeghi, Duygu Tosun, J. Craig Nelson, Scott Mackinn
- P59 Cortical Thickness and Executive Function in Late Life Depression
Krista Farley, David Bickford, Yiu Ho Au, Kelly B. Scherer, J. Craig Nelson, Scott Mackinn, Duygu Tosun
- P60 Subclinical Depression in Community dwelling Elderly of Rural Nigeria
Olusegun Baiyewu, Abdulkareem Jika Yusuf, Adefolakemi Temitopee Ogundele
- P61 Evaluation of 5HTTLPR and BDNF rs6265 polymorphism in a Brazilian elderly population
Thais Chile, Gisele Rodrigues Gouveia, Homero Pinto Vallada Filho, Helena Brentani, Clovis Alexandrino-Silva, Salma Rose Imanari Ribeiz, Cassio Machado De Campos Bottino
- P63 Are the correct tools used in the geriatric depression studies? A review of the literature from methodological perspectives
Ying-Jyun Shih, Hsuan-Jui Chang, Yung-Jen Yang
- P67 Structural Brain Changes Associated with Positive Response to Psychotherapeutic Treatment
Kelly B. Scherer, David Bickford, Yiu Ho Au, Krista Farley, Scott R. Mackinn, J. Craig Nelson, Duygu Tosun-Turgut, Michael W. Weiner, Derek D. Satre
- P68 Assessing Cognitive Function in Elderly Chinese Immigrants
Clara Li, Judith Neugroschl, Carolyn Zhu, Mari Umpierre, Jane Martin, QiYing Huang, Xiaoyi Zeng, Mary Sano

SCIENTIFIC PROGRAM - POSTERS

- P69 Clinical Utility and Patient Acceptability of the Six-Item Cognitive Impairment Test (6-CIT) as a Cognitive Screening Tool in the Acute Hospital Setting
Clodagh Power, Richard Duffy, Helena Bates, Mike Healy, Petrina Gleeson, Elaine Greene
- P70 The Dementia Outcomes Measurement Suite: facilitating dementia assessment
Adam Bentvelzen, Liesbeth Aerts, Katrin Seeher, Belinda Goodenough, Henry Brodaty
- P71 Comparison of DSM-IV and DSM-5 dementia criteria among elderly with low education levels living in a developing country
Rebeca Mendes Pessoa, Natália Mota S. Chagas, Livio R. Leal, Marcos Hortes N. Chagas
- P72 Comparison between two brief cognitive screening tools in a psychogeriatric outpatient clinic
Natália Moto S. Chagas, Marcos Hortes N. Chagas
- P73 Higher heart rate and leukocyte count associated with coronary heart disease in old patients with bipolar disorder
Shang-Ying Tsai, Yen-Kuang Lin, Pao-Huan Chen, Meng-Ling Chen
- P74 Potentially inappropriate medications in the elderly in Korean long-term care facilities
Kang Soo Lee
- P75 The association between Psychological and Social factors at work and the degree of Person Centred Care in Nursing Homes
Irene Røen, Geir Selbaek, Oyvind Kirkevold, Ingelin Testad, Knut Engedal, Sverre Bergh
- P76 The effect of the Initial-phase Intensive Support Team for dementia in Maebashi City, Japan
Tomoharu Yamaguchi, Masamitsu Takatama, Haruyasu Yamaguchi
- P77 The course of quality of life in nursing home residents with dementia
Anne Van Der Zon, Roland Wetzels, Hans Bor, Raymond T. Koopmans, Debby Gerritsen
- P78 Differences in the neural correlates of frontal lobe tests
Teruyuki Matsuoka, Yuka Kata, Ayu Imai, Hiroshi Fujimoto, Keisuke Shibata, Kaeko Nakamura, Kei Yamada, Jin Narumoto
- P79 Identifying research directions for a radiological nursing approach in elderly care in Japan
Miwa Yamamoto, Yoko Miyoshi, Junko Yoshimura, Yusuke Sakurai, Kiyoko Tokunaga
- P80 Executive Function Performance Test-Br in Alzheimer Disease: cultural adaptation and inter rater reliability
Patricia C. Buchain, Adriana Vizzotto, Janaina Harder, Patricia Cotting Homem de Mello, Alexandra M. Oliveira, Tania C.T.F. Alves
- P81 Healthcare costs among chronically ill older adults: does mental health status matters?
Samantha Gontijo Guerra, Helen-Maria Vasiliadis, Veronica Chudzinski
- P82 Worry and depressive symptoms are associated with subjective memory complaints
Victoria Liou-Johnson, Nehjla M. Mashal, Abigail Kramer, Nathan Hantke, Nicholas T. Bott, Sherry A. Beaudreau
- P83 Older Adults, Mental Health Prevention & Promotion: Aspects of CBA, CUA and CEA Analysis
Sabine Bährer-Kohler
- P84 Is the experienced stigma in dementia related to clinical symptoms and quality of life? The MeetingDem project
Joanna Rymaszewska, Katarzyna Urbanska, Dorota Szczesniak, Elisabetta Farina, Francesca Lea Saibene, Rabih Chattat, Simon Evans
- P85 Cohort differences in cognitive aging in the Longitudinal Aging Study Amsterdam (LASA)
Anamaria Brailean, Martijn Huisman, Martin James Prince, Matthew Prina, Dorly Deeg, Hannie Comijs
- P86 The Successful Use of Electroconvulsive Therapy to Treat Akathisia
A Umair Janjua, Meena Kumari, Adriana Hermida
- P87 Electroconvulsive Therapy (ECT) in a Heart Transplant Patient
Adriana Hermida, Oliver Glass
- P88 Trichotillomania in Geriatrics: a Case Report
Mairead M. Bartley, Maria Lapid
- P89 Analyzing Berg Balance Scale and Time Up and Go test in people with Parkinson's disease: Video Game as an intervention method
Livia Galeote, Juliana F. Cecato, Marcos O. Martienlli, Raissa B. Marraccini, Jose Eduardo Martinelli
- P90 Difference between Older Japanese Inpatients and Outpatients in Occupational Performance, Health-related QOL, and Well-being
Emi Miki, Risa Matsuo
- P91 The efficacy of individual occupational therapy in a long-term schizophrenic inpatient: A case study
Fumiko Kaneko, Hitoshi Okamura
- P92 Development of an E-learning for Caregivers to Manage Challenging Behavior of People with Dementia
Iris Van Asch, Marleen Prins, Bernadette Willemse
- P93 A Novel Psychosocial Intervention "Programme d'Aide au Succès du Sevrage" (PASSE-65+) Designed to Help Older Benzodiazepine Users to Gradually Wean Their Medication: An Overview of the Protocol
Fethia Benyebdri, Virginie Proulx-Tremblay, Marie-Michelle B. Duhaime, Vanessa Léveillé, Arnaud Allary, Guilhème Pérodeau, André Marchand, Kieron O'Connor, Cara Tannenbaum, Pasquale Roberge, Helen-Maria Vasiliadis, Carol Hudon, Sebastien Grenier



SCIENTIFIC PROGRAM - POSTERS

- P94 A Novel Psychosocial Intervention Designed to Help Older Benzodiazepine Users to Gradually Wean Their Medication: Preliminary Evidence for its Effectiveness
Fethia Benyebdri, Virginie Proulx-Tremblay, Marie-Michelle B. Duhaime, Vanessa Léveillé, Arnaud Allary, Guilhème Pérodeau, André Marchand, Kieron O'Connor, Cara Tannenbaum, Helen-Maria Vasiliadis, Pasquale Roberge, Carol Hudon, Sebastien Grenier
- P95 Integrated On-Site Mental Health Services: Better Access and Care for Seniors in Need
Amy Bunn, Irena Ginsburg, Jay Luxenberg
- P96 User satisfaction with vacuum pump treatment for erectile dysfunction amongst middle- and older-aged primary care patients
Victoria Liou-Johnson, Katie Van Moorlegem, Johanna Rengifo, Viktoiya Samarina, Brent Mills, Sherry A. Beaudreau
- P97 Comparison of self-harm between elderly and younger adult inpatients at a general hospital, a two-year data analysis
Cheng-Chen Chang, Si-Sheng Huang
- P98 Reminiscence therapy for geriatric depression- a systematic review of randomized controlled trials with meta-analysis
Hsuan-Jui Chang, Yung-Jen Yang, I-Ching Lin
- P99 Association between benzodiazepine use and post-traumatic stress syndrome among older adults
Catherine Lamoureux Lamarche, Helen-Maria Vasiliadis
- P100 Bone Truths? Exploring the Impact of Antidepressants on Bone Health
Clodagh Power, Richard Duffy, James Mahon, Nessa Fallon, Georgina Steen, Elaine Greene, Brian A. Lawlor, Joseph Browne, MC Casey, JB Walsh, Kevin McCarroll
- P101 A Complete Service Network (CSN) for the Mental Health Care of Older Adults
Ralf Ihl

EXHIBITORS DIRECTORY

Exhibits are located in the Golden Gate Ballroom and will be open:

Tuesday, 6 September 16:00-20:30

Wednesday, 7 September 09:30-18:00

Thursday, 8 September 09:30-18:00

CAMBRIDGE UNIVERSITY PRESS

A world leader in academic publishing, Cambridge publishes more than 1,500 new academic and professional books annually, and more than 350 peer-reviewed academic journals. Many of these journals are leading academic publications in their fields and together form one of the most valuable and comprehensive bodies of research available today.

For more information, please visit www.cambridge.org

ALZHEIMER'S RESEARCH AND PREVENTION FOUNDATION

The ARPF provides an alternative to the conventional, "magic bullet" drug approach. We believe that you can help yourself, right now, by utilizing a holistic or integrative medical approach, based on the lifestyle tools we advocate. Modern medical research reveals that all of the aspects of the ARPF's Four Pillars of Prevention Plan, including physical and mental exercise, especially when used together, help build a healthier and stronger brain and memory.

For more information, please visit <http://www.alzheimersprevention.org/>

INTERNATIONAL PSYCHOGERIATRIC ASSOCIATION (IPA)

Founded in 1982, the International Psychogeriatric Association (IPA) is a unique and diverse professional healthcare community promoting better geriatric mental health – across disciplines, across borders, and across geriatric issues. Psychiatrists, Scientists, Neurologists, Geriatricians, Primary Care Physicians, Epidemiologists, nurses, Psychologists, Occupational Therapists, Social Workers, and many other healthcare professionals come to the IPA community from all around the world to discuss, learn, share, and research information about behavioral and biological aspects of geriatric mental health.

For more information, please visit: www.ipa-online.org

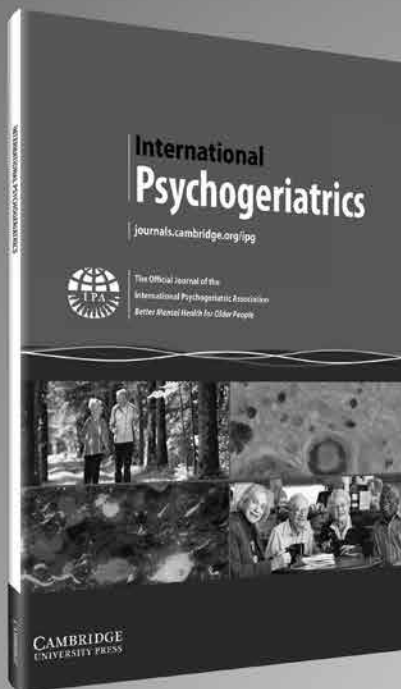

International Psychogeriatrics



The Official Journal of the
International Psychogeriatric Association

Editor-in-Chief
Nicola T. Lautenschlager,
University of Melbourne, Australia

cambridge.org/ipg

A highly respected, multidisciplinary journal, *International Psychogeriatrics* publishes high quality original research papers in the field of psychogeriatrics. The journal aims to be the leading peer reviewed journal dealing with all aspects of the mental health of older people throughout the world.

*2015 Journal Citation Reports®, Thomson Reuters

Sign up for content alerts: cambridge.org/ipg/alerts

Submit your paper: cambridge.org/ipg/submit

A subscription to *International Psychogeriatrics* is included with each IPA membership. For more information, please visit their website:
www.ipa-online.org



The Official Journal of the
International Psychogeriatric Association
Better Mental Health for Older People



CAMBRIDGE
UNIVERSITY PRESS