

2016 IPA International Psychogeriatric Association Asian Regional Meeting

9–11 December 2016, Taipei, Taiwan

Venue: NTUH International Convention Center



PROGRAM BOOK

*Safety and Integrated Care in Aging Mental Health:
Cross-cultural Perspectives*

Date: 2016/12/9-11

Venue: NTUH International Convention Center

www.ipa-ar2016.tw



CONTENT

- 02** • Program at-a-glance
- 05** • Welcome Letter
- 08** • Meeting Organizer & Committee
- 10** • Invited Speaker
- 12** • Information for Oral Presenter
- 13** • Daily Program
 - 13** • Friday, December 9
 - 14** • Saturday, December 10
 - 19** • Sunday, December 11
- 23** • Information for Poster Presenter
- 24** • Poster Presentation
- 34** • Acknowledgement
- 36** • General Information
- 38** • Venue
- 39** • Floor Plan & Exhibition
- 42** • Social Program
- 43** • Tourist Attraction

Program at-a-glance

Date	December 9, 2016 (Friday)		
Time\Room	Room 201	Room 203	Room 402 AB
09:00-10:30			Workshop 1 <i>Imaging and Biomarkers Workshop</i>
10:30-10:45			Coffee Break
10:45-12:00			Workshop 1 <i>Imaging and Biomarkers Workshop</i>
12:00-12:15		Tripartite Meeting <i>(by Invitation)</i>	
12:15-13:30			
13:30-15:00			Workshop 2 <i>Clinical Challenges in Geriatric Psychiatry</i>
15:00-15:15			Coffee Break
15:15-16:45			Workshop 2 <i>Clinical Challenges in Geriatric Psychiatry</i>
16:45-17:00			
17:00-17:30	Opening Ceremony		
17:30-18:30	Keynote Lecture <i>Integrated Care and Safety Issues in the Aging Mental Health</i>		

Registration	08:00-19:30 @Corridor, 2F
Exhibition	
Poster	
Social Event	Welcome Reception: 18:30-20:00 @Room 101, 1F

Date	December 10, 2016 (Saturday)		
Time\Room	Room 201	Room 203	Room 301
09:00-10:00	Plenary Lecture 1 <i>Aging and Mental Health-strategy for Prevention against Cognitive Impairment of the Elderly/ Suicide Prevention</i>		
10:00-10:30	Coffee Break		
10:30-12:00	Symposium 1 <i>Asian Symposium on Safety and Integrated Care in Aging Mental Health: Cross-cultural Perspectives</i>	Oral Session 1 <i>Neurobiological Studies in Mild Cognitive Impairment and Dementia</i>	Symposium 2 <i>Successful Ageing vs. Frailty in Exceptional Longevity: Centenarians' Health and Well-being in Perspective</i>
12:00-13:30	Lunch Symposium 1 <i>IMR Technique Makes Alzheimer's Disease Blood Test Possible</i>	Lunch Symposium 2 <i>Management of Difficult-to-Treat Mood Disorder in Elderly Patients</i>	
13:30-14:30	Plenary Lecture 2 <i>The Association between Vascular Factors and Cognitive Impairment and Depression</i>		
14:30-16:00	Symposium 3 <i>New Technology in Psychiatry: NIRS and MRI Application on Geriatric Psychiatry</i>	Oral Session 2 <i>Anxiety and Depression in Late Life</i>	Symposium 4 <i>Late-life Mood Disorders- Emerging Perspectives</i>
16:00-16:45	Coffee Break Poster Session 1		
16:45-18:15	Symposium 5 <i>Frontotemporal Lobar Degeneration (FTLD) in Asia</i>	Oral Session 3 <i>Epidemiological Studies in Dementia</i>	Symposium 6 <i>Lifestyle, Cognitive Function and Quality of Life in the Elderly</i>
Registration	08:00-17:30 @Corridor, 2F		
Exhibition	08:30-18:00 @Lobby, 2F		
Poster	09:00-18:00 @Lobby, 3F		
Social Event	Gala Dinner: 18:30-20:30 @Room 101, 1F		

Date	December 11, 2016 (Sunday)		
Time\Room	Room 201	Room 203	Room 301
09:00-10:00	Plenary Lecture 3 <i>Old Age Bipolar Disorder</i>		
10:00-10:30	Coffee Break		
10:30-12:00	Symposium 7 <i>Dementia of Lewy Bodies: Animal Model, Neuroimaging Findings and Sleep Disorder</i>	Oral Session 4 <i>Medical Morbidity and Cognitive Impairment in Psychogeriatric Patients</i>	Symposium 8 <i>Frailty and Psychogeriatric Syndromes</i>
12:00-13:30	Lunch Poster Session 2 (12:30-13:15)		
13:30-14:30	Plenary Lecture 4 <i>Molecular Imaging for Dementia and Depression</i>		
14:30-16:00	Symposium 9 <i>Transitions in Late Life Suicide</i>	Oral Session 5 <i>Approaches to Cognitive Enhancement and Active Aging</i>	Symposium 10 <i>Mental Capacity and Law</i>
16:00-16:30	Coffee Break		
16:30-18:00	Symposium 11 <i>Mild Cognitive Impairment: Diagnostic Stability, Biomarkers and Neuropsychiatric Predictors</i>	Oral Session 6 <i>Burden, Support and Life Transformation of Caregivers Looking after Dementia Patients</i>	Symposium 12 <i>The Paradigms and Challenges of Psychogeriatric Service Delivery</i>
Registration	08:30-16:30 @Corridor, 2F		
Exhibition	08:30-16:30 @Lobby, 2F		
Poster	09:00-16:30 @Lobby, 3F		

Welcome Letter



Raimundo Mateos

IPA President

Dear colleagues,

It is a great pleasure for me to offer you the most cordial welcome to the 2016 IPA International Meeting.

This event is the result of a coordinated effort between the International Psychogeriatric Association and the Taiwanese Society of Geriatric Psychiatry, which I am proud to propose as a model of collaboration for IPA affiliated societies. The organizing and scientific committees have worked intensely to make possible an event that we are sure will be stimulating from the professional point of view. If we add to this fact the proverbial Taiwanese hospitality, I have no doubt it will be a success.

On behalf of the International Psychogeriatric Association we thank you for attending this Meeting.

Welcome Letter



Te-Jen Lai



Masatoshi Takeda



Tzung-Jeng Hwang



Manabu Ikeda

Organizing Committee Co-Chairs

Scientific Committee Co-Chairs

Dear Colleagues,

On behalf of the Organizing Committee, we would like to extend our warmest welcome to all colleagues, and to thank you for participating in the International Psychogeriatric Association Asian Regional Meeting (IPA-AR 2016) held in Taipei, Taiwan from December 9 to 11, 2016.

As the co-chairs of IPA-AR 2016, we are pleased to announce that the meeting has attracted more than 400 delegates from 24 countries all over the world. According to the theme of the meeting, "Safety and Integrated Care in Aging Mental Health: Cross-cultural Perspectives", we are ready to advance geriatric research and to build a platform for international exchange.

We cordially invite you to experience this opportunity for cross-cultural collaboration, alongside a glimpse into Taiwan's diverse ways of life, a taste of our various cuisines in the vibrant city of Taipei, and a connection to the beauty and hospitality of this island. Once again, welcome to Taipei. We wish you a memorable and wonderful stay on Formosa.



Taipei City Government

Wen-Je Ko, Ph.D.
Mayor

Office of the Mayor
Taipei, Taiwan, Republic of China

臺北市市長 柯文哲

Greetings, dear friend!

On behalf of the people of Taipei, I'd like to welcome you on your visit to our city.

Taipei is a wonderfully diverse international metropolis with a strong and soaring city identity built on our safe travel environment, ultra-convenient transportation network, friendly and hospitable people, unique culture and scenic attractions. Our objective is now to make Taipei a city of cultural intelligence, synthesizing our unique cultural aesthetics, intelligent technology and cross-industry strengths and advantages. I invite you to explore our delicious food and enticing scenery that I am sure will make your stay unforgettable and leave you with many memories that you will cherish.

As part of our efforts to make our city even more welcoming, Taipei has unveiled a new "Taipei ABC" approach built around a new intelligent tourism design. ABC stands for **App, Bus, Culture**. We use high-tech to eliminate travel barriers by offering travel apps in numerous languages and providing cross-functional online services. Our tourism-oriented bus routes connect the many distinctive neighborhoods and scenic sights of the city's oldest districts on the west side, immersing you in the Taipei of yesteryear. Finally, the meticulously crafted culture tour itineraries have been developed to transport you deep into the world of Taipei's rich traditional culture, cuisine and historical ambience, so that you can experience first-hand one of the city's most striking features—the harmonious coexistence of traditional culture with the most advanced technology.

Taipei has on several occasions been rated by the international media as one of the world's premier travel destinations. Here is a place where old and new are seamlessly intertwined, where tradition and innovation live in a charming synthesis. We offer the visitor a marvellously diverse array of special themed tour itineraries and delicious local culinary delicacies. By increasing the number and quality of our tourism services, and with our creative added-value, we help you to experience our beautiful and unique city in an authentic and enjoyable way. We're sure you'll love it!

Sincerely

Wen-Je Ko

Wen-Je Ko

Meeting Organizer & Committee

Meeting Organizer *(Alphabetic Order in Letter)*

Host Organization



International Psychogeriatric
Association



Taiwanese Society of
Geriatric Psychiatry

Collaborating Organization

Hong Kong Psychogeriatric Association
Japanese Psychogeriatric Society
Korean Association for Geriatric Psychiatry
Psychogeriatric Interest Group of the Chinese Society of Psychiatry
Taiwan Alzheimer's Disease Association
Taiwan Association of Family Medicine
Taiwan Association of Gerontology and Geriatrics
Taiwan Dementia Society
Thai Society for Geriatric Psychiatry and Neuropsychiatry (TSGN)

Meeting Committee *(Alphabetic order in Country and Last Name)*

Organizing Committee

Co-chair

Masatoshi Takeda	Japan	Te-Jen Lai	Taiwan
------------------	-------	------------	--------

Member

Henry Brodaty	Australia	Tzung-Jeng Hwang	Taiwan
Manabu Ikeda	Japan	Yung-Jen Yang	Taiwan
Raimundo Mateos	Spain		

Scientific Committee

Co-chair

Manabu Ikeda	Japan	Tzung-Jeng Hwang	Taiwan
--------------	-------	------------------	--------

Member

Henry Brodaty	Australia	Doh-Kwan Kim	South Korea
Brian Draper	Australia	Guk-Hee Suh	South Korea
Huali Wang	China	Raimundo Mateos	Spain
Helen Chiu	Hong Kong	Armin von Gunten	Switzerland
Masahiro Shigeta	Japan	Cheng-Sheng Chen	Taiwan
Masatoshi Takeda	Japan	Te-Jen Lai	Taiwan
Raymond Koopmans	Netherlands	Jay Luxenberg	United States

Local Organizing Committee

Ching-Chi Chang	Taiwan
Ching-Jui Chang	Taiwan
Chun-Wei Chang	Taiwan
Jian-Kang Chao	Taiwan
Kun-Po Chen	Taiwan
Chao Huang	Taiwan
Jen-Ping Hwang	Taiwan
Kai-Dih Juang	Taiwan
Tsuo-Hung Lan	Taiwan
Chun-Te Lee	Taiwan
Shwu-Hua Lee	Taiwan
Shih-Cheng Liao	Taiwan
Yi-Cheng Liao	Taiwan
Wen-Chen Ouyang	Taiwan
Ming-Chyi Pai	Taiwan
Shang-Ying Tsai	Taiwan
Hin-Yeung Tsang	Taiwan
Nian-Sheng Tzeng	Taiwan

Scientific Advisory Committee

Siu-Wah Li	Hong Kong
Doh Kwan Kim	South Korea
Pichet Udomratn	Thailand
John O'Brien	United Kingdom
George Grossberg	United States

Invited Speaker

(Order by Arranged Session Date)

Workshop

December 9, 2016 (Friday) @Room 402AB, 4F



09:00-12:15

Prof. John O'Brien (United Kingdom)

Department of Psychiatry, University of Cambridge

Topic: Imaging and Biomarkers Workshop



13:30-16:45

Prof. George Grossberg (United States)

Departments of Neurology & Psychiatry, Anatomy and Neurobiology and Internal Medicine

Director, Division of Geriatric Psychiatry Saint Louis University School of Medicine St. Louis, Missouri

Topic: Clinical Challenges in Geriatric Psychiatry

Keynote Lecture

December 9, 2016 (Friday) @Room 201, 2F



17:30-18:30

Prof. Henry Brodaty (Australia)

Scientia Professor of Ageing and Mental Health, Director of the Dementia Collaborative Research Centre and Co-Director of the Centre for Healthy Brain Ageing at the University of New South Wales

Topic: Integrated Care and Safety Issues in the Aging Mental Health

Plenary Lecture

December 10, 2016 (Saturday) @Room 201, 2F



09:00-09:30

Prof. Masatoshi Takeda (Japan)

President, Aino University

President, Japanese Society of Psychiatry and Neurology

President, World Federation of Societies of Biological Psychiatry

Topic: Aging and Mental Health-strategy for Prevention against Cognitive Impairment of the Elderly

December 10, 2016 (Saturday) @Room 201, 2F



09:30-10:00

Prof. Helen Chiu (Hong Kong)

Professor of Psychiatry at the Chinese University of Hong Kong and President of the Hong Kong Psychogeriatric Association

Topic: Suicide Prevention

December 10, 2016 (Saturday) @Room 201, 2F



13:30-14:30

Prof. John O'Brien (United Kingdom)

Department of Psychiatry, University of Cambridge

Topic: The Association between Vascular Factors and Cognitive Impairment and Depression

December 11, 2016 (Sunday) @Room 201, 2F



09:00-10:00

Prof. Martha Sajatovic (United States)

Department of Psychiatry, University Hospitals of Cleveland

Topic: Old Age Bipolar Disorder

December 11, 2016 (Sunday) @Room 201, 2F



13:30-14:30

Prof. Kun-Ju Lin (Taiwan)

Associate Professor and Director, Department of Nuclear Medicine, Linkou Chang Gung Memorial Hospital, Taoyuan, Taiwan

Healthy Aging Research Center and Medical Imaging and Radiological Sciences, Chang Gung University, Taoyuan, Taiwan

Topic: Molecular Imaging for Dementia and Depression

Information for Invited Speaker & Oral Presenter

- Please provide and test your presentation slides at least **ONE Hour Before** the session at Speaker-ready Room (Room 202, 2F).
- Please arrive at your session room at least **20 Minutes Before** the session starts and meet the session moderator and re-confirm your presentation slides.
- The Meeting staff will be at each session room to provide any relevant assistance.
- Each session room will be equipped with the laptop (installed with Windows 8, Microsoft PowerPoint 2013) and a LCD projector. **It is highly encouraged that all speakers to use the provided laptop to** prevent any technical problem and save the installation time.
- If you plan to use your own laptop, please bring any necessary electrical adaptors and connectors for your laptop. We DO NOT provide any of them.
- Please prepare a backup copy in the USB drive for your video clips.
- Please kindly and strictly control the time duration for each presentation according to the allotted.

Category	Total	Lecture	QA
Keynote	60 mins	60 mins	0
Plenary 1	30 mins	30 mins	0
Plenary 2-4	60 mins	60 mins	0
Workshop	Determined by Session Moderator /Speaker		
Symposium	Determined by Session Moderator		
General Oral	18 mins	15 mins	3 mins

Daily Program

December 9, 2016 (Friday)

09:00-12:15 **Room 402 AB**

Workshop 1

Imaging and Biomarkers Workshop

Moderator: Tzung-Jeng Hwang (Taiwan)

W1-01 Imaging and Biomarkers Workshop
John O'Brien (United Kingdom)

12:00-13:30 **Room 203**

Tripartite Meeting (By Invitation)

Moderator: Te-Jen Lai (Taiwan)

13:30-16:45 **Room 402 AB**

Workshop 2

Clinical Challenges in Geriatric Psychiatry

Moderator: Yung-Jen Yang (Taiwan)

W2-01 Clinical Challenges in Geriatric Psychiatry
George Grossberg (United States)

17:00-17:30 **Room 201**

Opening Ceremony

Te-Jen Lai (President, Taiwanese Society of Geriatric Psychiatry)

Raimundo Mateos (President, International Psychogeriatric Association)

17:30-18:30 **Room 201**

Keynote Lecture

Moderator: Te-Jen Lai (Taiwan)

KL Integrated Care and Safety Issues in the Aging Mental Health
Henry Brodaty (Australia)

December 10, 2016 (Saturday)

09:00-10:00

Room 201

Plenary Lecture 1

Moderator: Te-Jen Lai (Taiwan)

PL1-01 Aging and Mental Health-strategy for Prevention against Cognitive Impairment of the Elderly

Masatoshi Takeda (Japan)

PL1-02 Suicide Prevention

Helen Chiu (Hong Kong)

10:30-12:00

Room 201

Symposium 1

Asian Symposium on Safety and Integrated Care in Aging Mental Health: Cross-cultural Perspectives

Moderator: Manabu Ikeda (Japan); Tzung-Jeng Hwang (Taiwan)

S1-01 Integrated Care for Elderly People with Dementia: The Japanese Perspective
Manabu Ikeda (Japan)

S1-02 Intergrated Care and Safety Issues in Aging Mental Health: The Taiwan Perspective

Tzung-Jeng Hwang (Taiwan)

S1-03 I Want to Live at Home to Death

Guk-Hee Suh (South Korea)

S1-04 Getting Lost among People with Dementia: Risk and Care Strategies
Huali Wang (China)

10:30-12:00

Room 203

Oral Session 1

Neurobiological Studies in Mild Cognitive Impairment and Dementia

Moderator: Martha Sajatovic (United States); Hsien-Yuan Lane (Taiwan)

OS1-1 NMDA-related Biomarkers and Therapeutics for Cognitive Dysfunction
Hsien-Yuan Lane (Taiwan)

OS1-2 D-amino Acid Oxidase Level in the Peripheral Blood is Higher in Patients with Age-related Cognitive Decline

Chieh-Hsin Lin (Taiwan)

OS1-3 Plasma Biomarkers Associate with Cognitive, Agitation Symptoms and Regional Brain Atrophy in Alzheimer's Disease

Jung Lung Hsu (Taiwan)

- OS1-4** Overview of Drug Development by Pharmaceutical Industry for Alzheimer's Disease in Asia: 1996-2016
Chaucer C.H. Lin (Taiwan)
- OS1-5** Pathological and Aging-related Changes in EEG Alpha Activities During Eyes-open Rest and Memory Retention
Manson Cheuk-Man Fong (Hong Kong)
- OS1-6** Study of the Incidence of Characteristic Frequencies with Cutoff Amplitude at Different Brain Areas in EEG Spectrum Correlated with Early Alzheimer's Disease
Wei-Tsung Kao (Taiwan)

10:30-12:00

Room 301

Symposium 2

Successful Ageing vs. Frailty in Exceptional Longevity: Centenarians' Health and Well-being in Perspective

Moderator: Oscar M. Ribeiro (Portugal); Henry Brodaty (Australia)

- S2-01** Subjective Well-being of Centenarians and Super-centenarians in Japan
Masaru Mimura (Japan)
- S2-02** Successful Ageing and Age 100
Lia Araújo (Portugal)
- S2-03** Frailty and Depression in Centenarians
Oscar M. Ribeiro (Portugal)
- S2-04** International Prevalence of Dementia, Cognitive Impairment and Functional Dependence in Centenarians
Henry Brodaty (Australia)

12:00-13:30

Room 201

Lunch Symposium 1 - Eugene

IMR Technique Makes Alzheimer's Disease Blood Test Possible

Moderator: Tzung-Jeng Hwang (Taiwan)

- L1-01** IMR Technique Makes Alzheimer's Disease Blood Test Possible
Che-Chuan Yang (Taiwan)

12:00-13:30

Room 203

Lunch Symposium 2 - Otsuka

Management of Difficult-to-Treat Mood Disorder in Elderly Patients

Moderator: Te-Jen Lai (Taiwan)

- L2-01** Barriers and Options - the Role of Atypical Antipsychotics in Mood Disorder Among Elder Population
Siu-Wa Tang (Hong Kong)

13:30-14:30

Room 201

Plenary Lecture 2

Moderator: Cheng-Sheng Chen (Taiwan)

- PL2** The Association between Vascular Factors and Cognitive Impairment and Depression
John O'Brien (United Kingdom)

14:30-16:00

Room 201

Symposium 3

New Technology in Psychiatry: NIRS and MRI Application on Geriatric Psychiatry

Moderator: Tomohiro Shirasaka (Japan); Tsuo-Hung Lan (Taiwan)

- S3-01** New Technology in Psychiatry: NIRS and MRI Application on Geriatric Psychiatry
Tsuo-Hung Lan (Taiwan)
- S3-02** The Clinical and Research Application of fNIRS- Discovery of Diagnostic Signatures in Elderly Patients in Singapore
Cyrus Ho Su Hui (Singapore)
- S3-03** The Current Situation of Alcoholism in Japan: Alcohol-related Dementia and Mental Health Policy in Japan
Tomohiro Shirasaka (Japan)
- S3-04** The Scope of fNIRS Technology in Age Related Mental Disorder
Joerg Schnackenberg (Japan)

14:30-16:00

Room 203

Oral Session 2

Anxiety and Depression in Late Life

Moderator: Brian Draper (Australia); Masaru Mimura (Japan)

- OS2-1** Prevalence and Correlates of Anxiety among Persons with Dementia in the Norwegian Residential Cares
Alka Rani Goyal (Norway)
- OS2-2** Preliminary Study of N-3 Polyunsaturated Fatty Acid Supplementation in Patients with Late-life Depression to Prevent Recurrence of Depression
Chih-Chiang Chiu (Taiwan)
- OS2-3** Changes in the Age Patterns of Suicide in Selected Asian and Western Countries
John Snowdon (Australia)

- OS2-4** Relationship between Cognitive Decline and Depressive Mood of Thai Older People, a Primary Care Based Study
Supaporn Trongsakul (Thailand)
- OS2-5** Factors Associated with Anxiety and Depression in Chronic Obstructive Pulmonary Disease (COPD) Patients
Shwe Z. Nyunt (Burma)

14:30-16:00

Room 301

Symposium 4

Late-life Mood Disorders- Emerging Perspectives

Moderator: George T. Grossberg (United States); Cheng-Sheng Chen (Taiwan)

- S4-01** Diagnosis and Treatment of Late-life Mood Disorders in Long-term Care: Clinical and Research Issues
George T. Grossberg (United States)
- S4-02** The Impact of Depression and Depressive Symptomatology on Decision Making Capacity
Sanford I. Finkle (United States)
- S4-03** The Impact of Late-life Depression in Aging Societies
Cheng-Sheng Chen (Taiwan)

16:45-18:15

Room 201

Symposium 5

Frontotemporal Lobar Degeneration (FTLD) in Asia

Moderator: Manabu Ikeda (Japan); Ming-Chyi Pai (Taiwan)

- S5-01** Therapeutic Strategies of FTLD in Asia
Manabu Ikeda (Japan)
- S5-02** Obsession and Compulsion as Early Symptoms of Frontotemporal Dementia
Guk-Hee Suh (South Korea)
- S5-03** Neuroimaging Features of FTLD
Huali Wang (China)
- S5-04** The Need and Burden of Caregivers of Frontotemporal Lobar Degeneration (FTLD) in Taiwan
Sheng-Yu Fan (Taiwan)

16:45-18:15

Room 203

Oral Session 3

Epidemiological Studies in Dementia

Moderator: Raimundo Mateos (Spain); Jen-Ping Hwang (Taiwan)

- OS3-1** Prevalence of Symptoms of Dementia in East-Asian Cross-cultural Study (Episodic) Study
Kiyoko Makimoto (Japan)
- OS3-2** What Factors over the Life Course Are Contributing to High Rates of Dementia in Older Aboriginal Australians?
Brian Draper (Australia)
- OS3-3** Instrumental Activities of Daily Living as a Screening Tool for Dementia in Community Elderly Dwelling: Based on a Nation-wide Population Survey
Hui-Fen Mao (Taiwan)
- OS3-4** Concurrent Validity of the AD8 in Comparison with Diagnostic Criteria Based on NIA-AA Recommendation for All-cause Dementia
Yu Sun (Taiwan)
- OS3-5** Predicting the Natural Death in Elderly Psychiatric Male Patients with Long-stay Care
Chao-Cheng Lin (Taiwan)
- OS3-6** An Affect Education Model for Long-term Staff Caregivers Managing Behavioural and Psychological Symptoms of Dementia: A Feasibility Study
Ken Schwartz (Canada)

16:45-18:15

Room 301

Symposium 6

Lifestyle, Cognitive Function and Quality of Life in the Elderly

Moderator: Henry Brodaty (Australia); Pei-Ning Wang (Taiwan)

- S6-01** Dietary Habits and Dementia: A Nationwide Survey in Taiwan
Yu Sun (Taiwan)
- S6-02** Relationship between Cognitive Dysfunction and Health Related Quality of Life in Older Persons: A Nation Wide Population-based Survey in Taiwan
Yea-Ing Shyu (Taiwan)
- S6-03** Lifestyle and Prevention of Cognitive Decline in Late Life
Henry Brodaty (Australia)
- S6-04** Habitual Lifestyle Activities and Reversal of Mild Cognitive Impairment in the Singapore Longitudinal Ageing Studies
Xinyi Gwee (Singapore)

December 11, 2016 (Sunday)

09:00-10:00

Room 201

Plenary Lecture 3

Moderator: Shang-Ying Tsai (Taiwan)

- PL3 Old Age Bipolar Disorder
Martha Sajatovic (United States)

10:30-12:00

Room 201

Symposium 7

Dementia of Lewy Bodies: Animal Model, Neuroimaging Findings and Sleep Disorder

Moderator: John O'Brien (United Kingdom); Te-Jen Lai (Taiwan)

- S7-01** Brain Imaging Changes in Lewy Body Dementia
John O'Brien (United Kingdom)
- S7-02** Negative Correlation of Metabolism between Visual Association Cortex and Brainstem in Dementia with Lewy Bodies
Hideki Kanemoto (Japan)
- S7-03** Sleep Disorders in Dementia with Lewy Bodies
Naoko Tachibana (Japan)
- S7-04** Investigating Molecular Mechanisms of A β and α -Synuclein Synergistic Effects of Neurotoxicity and Behavioral Deficits in Dementia with Lewy Bodies
Chih-Li Lin (Taiwan)

10:30-12:00

Room 203

Oral Session 4

Medical Morbidity and Cognitive Impairment in Psychogeriatric Patients

Moderator: Helen Chiu (Hong Kong); Chao Huang (Taiwan)

- OS4-1** Frailty: The Trojan Horse in Dementia and Delirium
Wee Shiong Lim (Singapore)
- OS4-2** Comorbidity and Dementia: A Nationwide Survey in Taiwan
Ting Bin Chen (Taiwan)
- OS4-3** Polypharmacy and Cognitive Decline in Elderly Population: A Nationwide Population-based Survey
Chih-Ming Cheng (Taiwan)
- OS4-4** Health Profiles in Portuguese Centenarians: Findings from the Oporto Centenarian Study (PT100)
Laetitia Teixeira (Portugal)
- OS4-5** The Differences in Medical Morbidity, Cognitive and Social Function between Older Community-dwelling Patients with Bipolar Disorder and Schizophrenia
Shang-Ying Tsai (Taiwan)

10:30-12:00

Room 301

Symposium 8**Frailty and Psychogeriatric Syndromes***Moderator: Tze Pin Ng (Singapore); Constança Paúl (Portugal)*

- S8-01** Frailty Assessment in Elderly
Constança Paúl (Portugal)
- S8-02** Frailty and Delirium in Elderly People
Lia Fernandes (Portugal)
- S8-03** Physical Frailty, Cognitive Impairment and Depression
Tze Pin Ng (Singapore)
- S8-04** Frailty Interventions and Outcomes
Boon Yeow Tan (Singapore)

13:30-14:30

Room 201

Plenary Lecture 4*Moderator: Tzung-Jeng Hwang (Taiwan)*

- PL4** Molecular Imaging for Dementia and Depression
Kun-Ju Lin (Taiwan)

14:30-16:00

Room 201

Symposium 9**Transitions in Late Life Suicide***Moderator: Brian Draper (Australia); Shih-Cheng Liao (Taiwan)*

- S9-01** Regional Variation in Suicides by Age and Sex
Brian Draper (Australia)
- S9-02** Suicide Rates in Five-year Age-bands after the Age of 60 Years and Centenarians: The International Landscape
Sofia Laura Zarate Escudero (United Kingdom)
- S9-03** Suicide in Taiwanese Older Adults: From Survived Attempt to Mortality
Shih-Cheng Liao (Taiwan)
- S9-04** Suicide and Dementia in the Postmodern Era
Guk-Hee Suh (South Korea)
- S9-05** The Epidemiological Transition Hypothesis for Elderly Suicide Rates
Ajit Shah (United Kingdom)

14:30-16:00

Room 203

Oral Session 5

Approaches to Cognitive Enhancement and Active Aging

Moderator: Shwe Nyunt (Burma); Shwu-Hua Lee (Taiwan)

- OS5-1 Effectiveness of Treasure Hunt Memory Training Program (Mastery Level) for Person with Mild Cognitive Impairment (MCI) Living in Hong Kong
Chiu Lun Yu (Hong Kong)
- OS5-2 Emotional Impact of Museum Creative Aging Activities
Wan-Chen Liu (Taiwan)
- OS5-3 The Environment, Physical Activity and Cognitive Function of Older Persons
Shwe Z. Nyunt (Burma)
- OS5-4 Life Story Approach for Korean Older Couples Affected by Dementia
Jung-Hwa Ha (South Korea)

14:30-16:00

Room 301

Symposium 10

Mental Capacity and Law

Moderator: Sanford I. Finkle (United States); Kevin Chien-Chang Wu (Taiwan)

- S10-01 Does This Person Have Decision-making Capacity?
Sanford I. Finkle (United States)
- S10-02 International Comparison of Inheritance Law, Capacity and Will Contests in USA, France and China
Karen Reimers (Canada)
- S10-03 Civil Competence and Guardianship in the Elderly in Taiwan: Theories and Challenging Cases
Kevin Chien-Chang Wu (Taiwan)

16:30-18:00

Room 201

Symposium 11

Mild Cognitive Impairment: Diagnostic Stability, Biomarkers and Neuropsychiatric Predictors

Moderator: Jong-Ling Fuh (Taiwan); Yea-Ing Shyu (Taiwan)

- S11-01 MCI Stability and the Impact of Reversion on Dementia Risk
Liesbeth Aerts (Australia)
- S11-02 Mild Cognitive Impairment Reversion and Progression: Rates and Predictors in Community Living Older Persons in the Singapore Longitudinal Ageing Studies Cohort
Qi Gao (Singapore)

S11-03 Neurobiological Markers for Predicting the Progression from MCI to AD: The Review of MCI Studies in Taiwan

Pei-Ning Wang (Taiwan)

S11-04 The Prevalence and Predictive Value of Neuropsychiatric Symptoms in Mild Cognitive Impairment: Comparisons between Taiwanese and Western Studies

Tzung-Jeng Hwang (Taiwan)

16:30-18:00

Room 203

Oral Session 6

Burden, Support and Life Transformation of Caregivers Looking after Dementia Patients

Moderator: Raimundo Mateos (Spain); Wai Chi Chan (Hong Kong)

OS6-1 The Burden and Perceived Difficulties of the Carers of Older Dependents. A Community Study in Galicia, Spain

Raimundo Mateos (Spain)

OS6-2 Life Transformation among Family Caregivers Who Look after a Demented Family Member: Positive Experience Approaches

Chia-Ming Yen (Taiwan)

OS6-3 An Elicitation Study Exploring Vietnamese Community Healthcare Workers' Dementia Care Practice

Le Hong Huynh Truong (Vietnam)

OS6-4 Home-based Exercise for Depressive Symptoms among Carers of Persons with Dementia: Interim Findings

Wai Chi Chan (Hong Kong)

OS6-5 The Impacts of Wandering Dimensions on Family Caregivers' Sleep Disturbance

Yi-Chen Chiu (Taiwan)

16:30-18:00

Room 301

Symposium 12

The Paradigms and Challenges of Psychogeriatric Service Delivery

Moderator: Chui Ping Woo (Hong Kong); Yung-Jen Yang (Taiwan)

S12-01 Chances & Challenges in Ageing Era: Reengineering of CPH Psychogeriatric In-patient Nursing Services

Chui Ping Woo (Hong Kong)

S12-02 Psychogeriatric Service in Hospitals in Taiwan

Chia-Fen Tsai (Taiwan)

S12-03 Psychogeriatric Services in Community Mental Healthcare in Taiwan

Yung-Jen Yang (Taiwan)

S12-04 Integrated Mental Health Services: Managing Psychiatric Illness within Community Interdisciplinary Teams

Benjamin Kao (United States)

Information for Poster Presenter

- Presenting authors are required to set up their materials at designated hours according to the schedules.
- Poster Help Desk and the staff will be in service to assist on poster mounting. Adhesive tape will be provided on site. No paste, glue, thumbtacks or staples are permitted.
- Authors are encouraged to prepare a sufficient amount of a one-page handout to give to interested participants.
- All presenters should be present at the designated time to answer the questions.

Poster Presentation Schedule

Poster Session	Presentation Time	Poster Number	Mount the Poster	Dismantle the Poster
1	16:00-16:45, December 10, 2016	P-001~P-063	08:30-10:00, December 10, 2016	16:30-17:30, December 11, 2016
2	12:30-13:15, December 11, 2016	P-064~P-118		

*Author who would like to keep their poster should remove them before **17:30, December 11, 2016 (Sunday)**, or the organizer shall dispose all posters left after the removal time.

Poster Allocation

3F

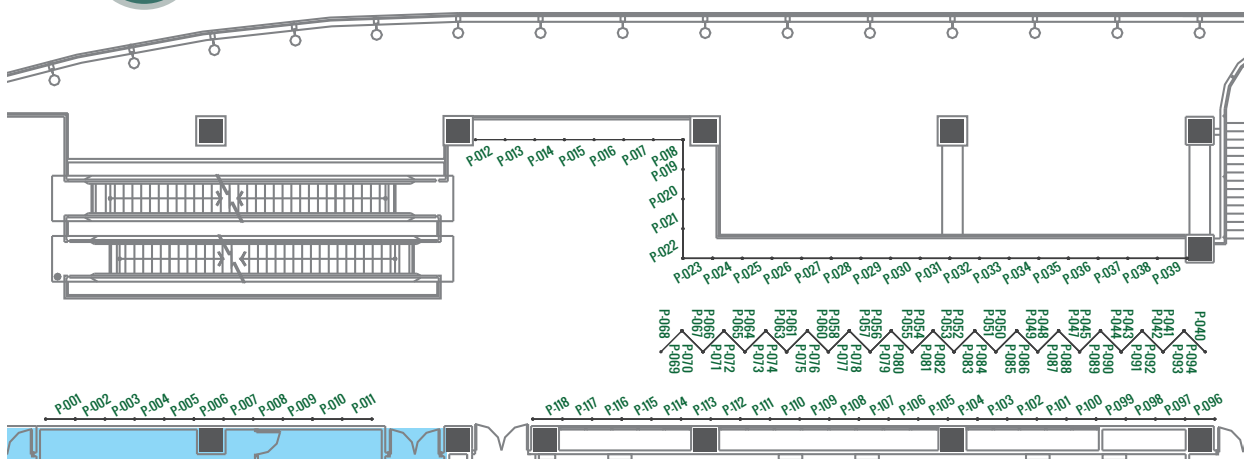

Poster Presentation

09:00-18:00, December 10-11 (Saturday-Sunday), 2016 @3F Lobby, 3F

Dementia, Mild Cognitive Impairment and Parkinson Disease

P-001	The Preventing Effect of Statin in Incidence of Dementia Che-Sheng Chu
P-002	Relations between Personality Changes and CSF Biomarkers of Alzheimer's Disease Pathology Armin Von Gunten
P-003	Diagnostic Potential of Magnetic Resonance Imaging with Phase Difference Enhanced Imaging (PADRE) for Alzheimer's Disease Ryuji Fukuhara
P-004	Family Empowerment for Management of Alzheimer's Disease Dong-Woo Lee
P-005	Structural Brain MRI in Elders with Subjective Memory Complaint, Mild Cognitive Impairment and Alzheimer's Dementia: Results from Brain Network Analyses Hyun-Ghang Jeong
P-006	Risk of Alzheimer's Disease and Angiotensin Receptor Blockers Chia-Liang Wu
P-007	Hippocampal Amyloid Burden with Downstream Fusiform Gyrus Atrophy Correlate with Face Matching Task Scores in Early Stage Alzheimer's Disease Ya-Ting Chang
P-008	Impact of Alzheimer Disease into Daily Life Activities Nilda Henriquez
P-009	Stigmatic Experiences of Israeli Arab Caregivers of Persons with Alzheimer's Disease Hanan Abojabel
P-010	Periodontitis Could Be a Modifiable Risk Factor for Dementia Yao-Tung Lee
P-011	Cognition of Patients with Obstructive Sleep Apnea at Sleep Clinic King Chulalongkorn Memorial Hospital Chanon Sirikul
P-012	Mortality in the Elderly with Mild Cognitive Impairment- A 10-year Longitudinal Study Cheng-Sheng Chen

P-013	Can People with Mild Cognitive Impairment Drive Safely? A Pilot Study Bin-Huei Shih
P-014	Mobility Marker Associated with Cognitive Impairment in Elderly Chinese Immigrants Clara Li
P-015	Four-year Progression of Cognitive Function in a Clinical Sample of Patients with Alzheimer's Disease and Amnesic Mild Cognitive Impairment Asuka Koyama
P-016	Brain Atrophy is a Frequent Finding in Elderly Patients with First Episode Psychosis Ulla-Marja Louhija
P-017	FTD: A Review and a General Approach to Non-pharmacological Treatment Connie Tin Yee Yan
P-018	Frontaltemporal Dementia (FTD) Syndromes in Chinese: A Cohort Study in Hong Kong Daphne Siu Tuen Law
P-019	Visual Hallucinations and Delusion of Jealousy in a Doctor with Parkinson Disease Dementia: A Case Report Chi-Hung Lin
P-020	Electroconvulsive Therapy for Treatment of Parkinson's Diseases with "On-off" Phenomenon: A Case Series Tak Youn
P-021	Visual Hallucinations in Taiwanese Patients with Parkinson's Disease Dementia Ling-Ying Dong
P-022	Performance on the Montreal Cognitive Assessment in Parkinson's Disease Dementia: A Comparison with Alzheimer's Disease Po-Ya Cheng
P-023	Frequency of Rem Sleep Behavior Disorder in Taiwanese Patients with Parkinson's Disease with or without Dementia Yuan-Chang Xie
P-024	Parkinson's Disease Dementia: New Therapy Ying-Jui Ho
P-025	The Revised Consensus Criteria for the Clinical Diagnosis of Dementia with Lewy Bodies Includes Milder Patients: Compared with the Original Criteria Pai-Yi Chiu

P-026	CEX Prevents Neuronal Deficits in DLB Rat Model Mei-Shiuan Shen
P-027	A Treatment for Neuronal Deficits in DLB Rat Model Shih Han Chang
P-028	Cognitive and Anxiety Disorder in DLB Rat Model Yi-Ru Chen
P-029	Personality, Cortisol, and Cognition in Non-demented Subjects: A Population-based Study Armin Von Gunten
P-030	Relationship between Serum Homocysteine Level, Alcohol Consumption and Partners of Dementia Patients Jian-Kang Chao
P-031	The Home Nursing Experience of Caring for an Elderly Fearing to Fall in Initial Dementia Stage Hsiao-Wen Lee
P-032	Trends of Visit of Dementia in Psychiatric Clinic Nan-Ying Chiu
P-033	Age and Gender Specific Incidence of Dementia in Taiwan- A Population-based Cohort Study Yun Ru Lu
P-034	The Analysis of Dementia Studies Using Taiwan's National Health Insurance Research Database Nian-Sheng Tzeng
P-035	Comparison of Memory Function between Idiopathic Normal Pressure Hydrocephalus and Alzheimer's Disease Takuya Matsumoto
P-036	A Case Report: Diversified Psychiatric Symptoms in Progressive Supranuclear Palsy Yu-Wen Chiu
P-037	Association of Brain White Matter Lesions and Atrophy with Cognitive Function in Chronic Kidney Disease Yi-Chun Yeh
P-038	Why Do People with Dementia Pretend to Know the Correct Answer? A Qualitative Study on the Saving Appearance Behaviors Masateru Matsushita

P-039	Sustained Benefit of a Psycho-educational Training Program for Dementia Caregivers in Taiwan Chien-Chi Hsu
P-040	Effects of Two Different Psycho-educational Training Programs for Dementia Caregivers in Taiwan: A Randomized Controlled Trial Chien-Chi Hsu
P-041	Anti-hypertensive Treatment in Relation to Cognitive Function in Later Life: A Systematic Review and Meta-analysis Chin Cheng
P-042	A Cohort Study of Patients with Dementia in Multiple Hospitals: Examination of Factors in Prolonged Hospitalization Akiko Katsuya
P-043	The Association between Cognitive Decline and Independency of ADL decline in VaD Kazuhiro Yoshiura
P-044	Recognition of Demented Patients in Psychiatric Consultations: Is It Different among Referral Departments? Jian-An Su
P-045	Admission of People with Dementia to Psychiatric Hospitals in Japan- Factors That Can Shorten Period of the Hospitalization Kiyoshi Maeda
P-047	Cross-cultural Comparison of the Pattern of Medication Use in Cognitively Impaired Residents in a Long-term Care Facility Saya Terada
P-048	Characteristics of Patients with Dementia and the Needs of Caregivers: Inpatient Versus Outpatient Status Seung-Ho Ryu
P-049	Word Production in Discourse and Cognitive Functions in Elderly- The Implication for the Demented Population Takako Yoshimura
P-050	Early and Late Stage Progressive Supranuclear Palsy- Two Case Reports Carol Sheei-Meei Wang
P-051	What Would You Do if You Developed Early-onset Dementia? A Postal Survey for Persons Aged 30-59 Years in Japan Miyae Yamakawa

P-052	A Cost Effective Solution in a Small Sydney Hospital: Designing a Close Observation Bay for Patients with Severe BPSD Tamara K. Rees
P-053	Behavioral and Psychological Symptoms of Depressed Dementia Patients in Taiwan Si-Sheng Huang
P-054	Effects of Relaxation Audio Technique Compared with Sleep Hygiene Advice on Sleep among Mild to Moderate Dementia, King Chulalongkorn Memorial Hospital Orawan Jaturasitha
P-055	DCRC_ABC Resources to Support the Management of BPSD Henry Brodaty
P-056	Behavioural and Psychological Symptoms: A Study of Portuguese Nursing Homes Carers Lia Fernandes
P-057	Immediate Report about the Impact of the 2016 Kumamoto Earthquake on Patients with Dementia Yusuke Miyagawa
P-058	Dextromethorphan-quinidine for Agitation in the Persons with Dementia: A Systematic Review Hsuan-Jui Chang
P-060	Development of “Ninchisho Chienowa-net” to Clarify and Propagate Effective Skills for Managing Behavioral and Psychological Symptoms of Dementia Hiroaki Kazui
P-061	Early Onset Dementia Diseases and Bpsd; Incidence, Prevalence, Diagnoses and Treatment in a Norwegian City Community Inger-Marie Tjernaes
P-063	The Experience of Combing Psychiatric and Neurologic Intervention in the First Dementia Ward in Taiwan Chia-Pei Lin

Anxiety, Depression, Suicide, Schizophrenia, Bipolar Disorder

P-064	Depression and Anxiety as Predictors of Frailty in a Two-year Follow-up Lia Fernandes
P-065	Risk of Vertebral Fracture in Patients Diagnosed with a Depressive Disorder: A Nationwide Population-based Cohort Study Li-Yu Hu
P-066	Risk of Hip Fracture in Patients with Depression: A Nationwide Population-based Retrospective Cohort Study Chih-Chuan Pan
P-067	Risk of Developing Suicidal Drug Overdose among Elder Patients with Depressive Disorders: A Population-based Cohort Study Chun-Hung Chang
P-068	Association of Depression with Sputum Smear Status and in Pulmonary Tuberculosis: A Cohort Study Jun-Jun Yeh
P-069	Validation of the Patient Health Questionnaire for Depression Screening among the Elderly Patients in Taiwan Shen-Ing Liu
P-070	Dementia or Geriatric Depression? The Results of a Screening Program for the Elderly with Chronic Illnesses. Yao-Tung Lee
P-071	The Risk of Depressive Disorders in Elder Women with Breast Cancer: A Population-based Study Shaw-Ji Chen
P-072	Characteristics of Elderly Residents Required Follow-up by Public Health Nurses with Depression Screening Survey in a Rural Area in Japan Yoshitomo Nishi
P-073	Aging Effect of Mitochondrial DNA Copy Number and Increased Oxidative Damage in Clinically Stable Patients with Major Depressive Disorder Cheng-Chen Chang
P-074	Pseudodementia Caused by Severe Depression: A Case Report Chen Lin Chang
P-075	Association between Vitamin D and Depression in Korean Older Workers Kang Seob Oh

P-076	Brain Topology Changes in Late-life Depression- A Resting-state Functional Imaging Study Shwu-Hua Lee
P-077	Pain as a Risk Factor for Suicide Behavior in Elderly People: A Systematic Review Lia Fernandes
P-078	Late-life Suicide Prevention Strategy in Changhua County Nan-Ying Chiu
P-079	Psychological Autopsy of Suicide for the Institutionalized Elderly Shyh-Jou Hwang
P-080	Factors Associated with Suicidal Ideation among Korean Elderly Using Welfare Center Jong-Il Park
P-081	Using Visual Stimulation to Analysis the Correlation on Elderly and Younger Schizophrenia Patients by EEG Signals Wen-Lin Chu
P-082	The Distribution of Facial Temperature for the Schizophrenia Patients of Different Ages Bo-Lin Jian
P-083	The Risk of Multiple Osteoporotic Fractures among the Patients with Schizophrenia Ching-Fen Chiang
P-084	A Unique Risk Factor Profile for Coronary Heart Disease in Older Patients with Bipolar Disorder Pao-Huan Chen
P-085	Factors Associated with Three-year Mortality in Elderly People with Bipolar Disorder Yi-Ju Pan
P-086	The Different Effects of Lithium and Valproate on the Various Cortical Regions of Elderly Patients with Bipolar Disorder Chia-Pei Lin
P-087	Association between Bipolar Disorder and the Subsequent Risk of Traumatic Brain Injury Mei-Feng Huang

Psychosocial Intervention, Caregiver Issues, Long Term Care, Service Delivery, Ethical Issues

P-088	The Perceived Benefits of a Cognitive Rehabilitation Group in New Zealand: A Qualitative Interview Study of Caregivers' Views and Experiences Isabelle Moebis
P-089	Effective Olfactory Stimulation of Reminiscence Intervention in Community-dwelling Elderly Persons in Japan Hideaki Hanaoka
P-090	Newly Implemented Rehabilitation for Dementia Inpatients of Psychiatric Hospitals in Japan Toshimichi Nakamae
P-091	Comprehensive Psychological Intervention Program in a Tertiary Gastroenterology Unit Beng Yeong Ng
P-092	Impact of Modified Namaste Care Programme on Patients with Advanced Dementia and Their Caregivers in a Step Down Unit Delwyn Lim
P-093	Effect of Five Ways to Well-being Program in Occupational Therapy for Elderly with Mood Disorder: A Pilot Study Leung Yue Yan
P-094	The Influence of Self-efficacy and Caregiving Appraisal on Depressive Symptoms among Dementia Family Caregivers in Taiwan Hsin-Yi Jennifer Liu
P-096	The Caregiver Burden of Patients with Frontotemporal Lobar Degeneration and Alzheimer's Disease in Taiwan Shu-Ching Lin
P-097	The Needs of Caregivers of Patients with Frontotemporal Lobar Degeneration Ya-Chuan Chou
P-098	How Caregivers of Persons with Alzheimer's Disease (AD) View Themselves Through Drawings Hanan Abo Jabel
P-099	Verification of a Screening Tool for Family Caregiver Burden for Caring Elderly Individual with Cerebrovascular Event in Taiwan Community Hui-Ying Lee

P-100	An Affect Education Model for Caregivers Managing Behavioral and Psychological Symptoms of Dementia in Long-term Care: A Study of Feasibility Kenneth Schwartz
P-101	Development and Verification of a Screening Instrument for Family Caregiver Burden for Caring Elderly Individual with Cancer in Taiwan Linen Nymphas Lin
P-102	A Qualitative Study on Carer-resident Relationship and Functional Status Change in Older Adults Receiving Residential Long-term Care Cheuk-Yan Karin Chu
P-103	The Age Affect the Frequency of the Pulmonary Tuberculosis, Lung Cancer and Pneumonia in Asthma-chronic Obstructive Pulmonary Disease Overlap Syndrome Jun-Jun Yeh
P-104	Integrated Mental Health Services: Managing Psychiatric Illness within Community Interdisciplinary Teams Benjamin Kao
P-105	Unmet Care Needs of the Demented Elderly in Taiwan Chen-Lan Shen
P-106	Psychogeriatric Service and Subspecialist Training in Taiwan: Implications and Challenges from On-file Data Yung-Jen Yang
P-107	Factors Relating to Outlooks on Life and Death among Caregivers in Elderly Facilities Miwa Yamamoto
P-108	Mental Capacity to Refuse Medical Treatment for Patients with Dementia I Ju Chen
P-109	Relations between Estimated Muscle Quantity and ADL/IADL in elderly people Miwa Yamamoto
P-110	Comparison of Anthropometric Measures for Evaluating the Association between Hypogonadism and Hypothalamic-pituitary-gonadal Hormones in an Older Taiwanese Ching-Yen Chen

Others

P-111	Disease Patterns of Hypnotic Use among Elderly Persons in Taiwan Chialun Kuo
P-112	The Value of Tc-99m ECD SPECT Analyzed by Easy Z-score Imaging System on Enhancing the Easy Diagnosis of Logopenic Progressive Aphasia: A Case Report Cheng-Yu Wei
P-113	Pulmonary Embolism in an Elderly During Treatment with Olanzapine and Antidepressants: A Case Report Hung-Yu Chan
P-114	Early Detection of Cognitive Impairment of Older People with Alcohol Use Disorder Ching Ling Kao
P-115	Clozapine-induced Eosinophilia in a Patient with Dementia Hung Chiang
P-116	A Retrospective, Chart-review Study for Patients with Dementia on Quetiapine Treatment Hung-Yu Chan
P-117	Evaluation Concepts and Practices of Understanding Museum Elder Participants Wan-Chen Liu
P-118	A Validation Study of Hong Kong Version of Apathy Evaluation Scale in Cognitively Impaired Older Chinese Wai Chi Chan

Acknowledgement

The IPA-AR 2016 Organizing Committee would like to extend its great gratitude to the following international/local organizations and sponsors who generously contribute and support to the success of the meeting.

Government

(Alphabetic Order in Letter)



Bureau of Foreign Trade, Ministry of Economic Affairs



觀光傳播局
Department of Information and Tourism

Department of Information and Tourism, Taipei City Government



Ministry of Health and Welfare

科技廳

Ministry of Science and Technology

Ministry of Science and Technology

Local Association



Taiwan Medical Association

Sponsors



General Information

Language

The official language of IPA-AR 2016 is English. Simultaneous translation is NOT available.

Registration Desk

Date	Service Hours	Location
Friday, December 9, 2016	08:00-19:30	Corridor, 2F
Saturday, December 10, 2016	08:00-17:30	
Sunday, December 11, 2016	08:30-16:30	

- Tour information desk is in service at the registration area during the registration hours and provides the relevant information of option tour.

Badge

For recognition, all participants are required to wear the badges at all times during the meeting period.

Lost & Found

Lost and Found items should be returned/ claimed at the Registration Counter.

Filming

Any kind of electronic filming (including camera phones and digital videos) are **NOT** allowed in session rooms.

Secretariat & Speaker-ready Room

Date	Service Hours	Location
Friday, December 9, 2016	08:00-19:30	Room 202, 2F
Saturday, December 10, 2016	08:00-17:30	
Sunday, December 11, 2016	08:30-16:30	

Wi-Fi Service

Public free Wi-Fi service is provided to all participants during the meeting period; please note that it might be limited access with heavy usage.

Lunch (Coupon Required)

Lunch boxes are provided as the location and time indicated as following:

Date	Time	Pick-up
Saturday, December 10, 2016	12:00-12:30	Lobby, 2F
Sunday, December 11, 2016	12:00-12:30	

Insurance

Public liability insurance will be made by IPA-AR 2016 during the meeting period (December 9-11, 2016). However, the Organizer shall not be liable for personal accidents or illness, losses and damages to private property of registered participants of the meeting.

Venue



Floor Plan & Exhibition

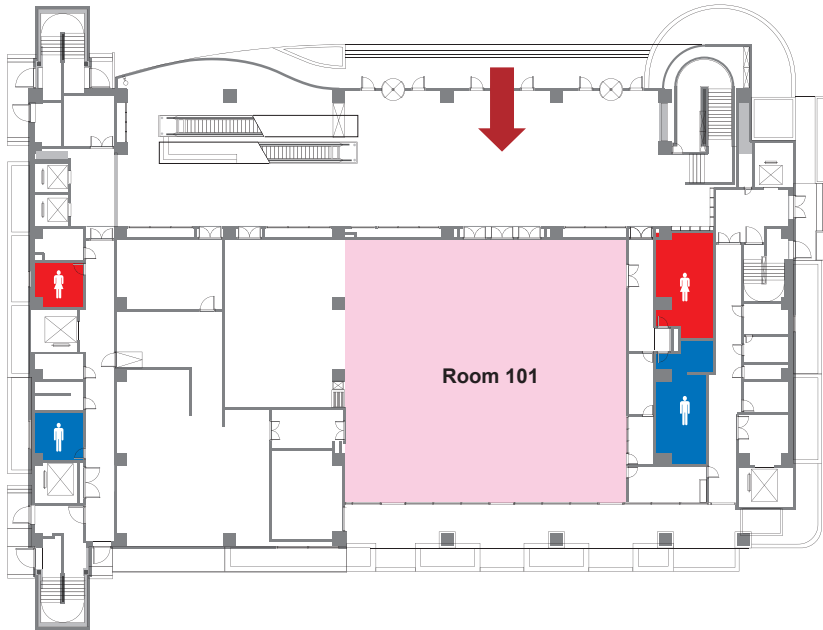

1F

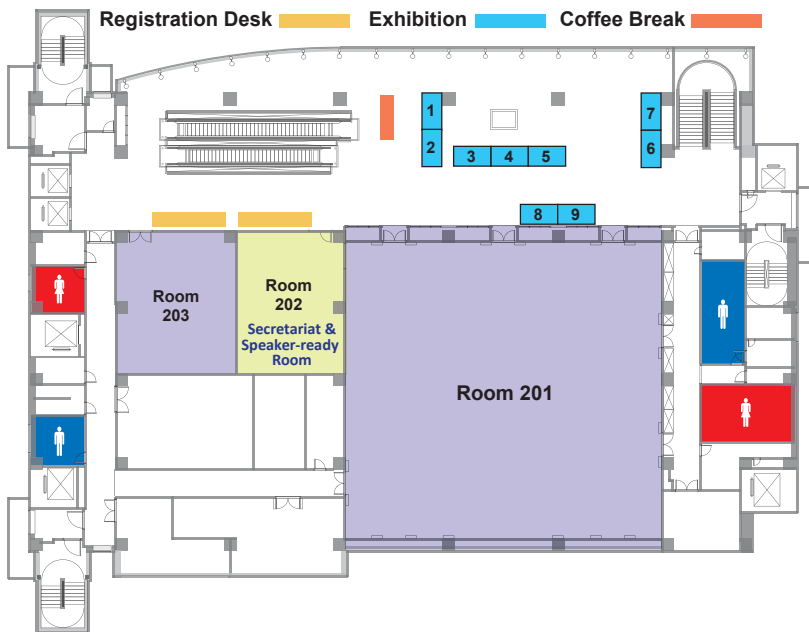

2F

Exhibition

The Exhibition is located at lobby area of 2nd floor of the venue. All participants are welcome to visit during the exhibition hours

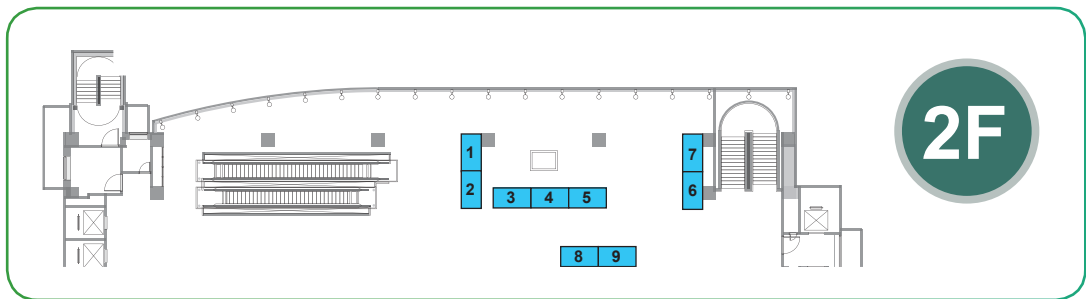

Booth No.	Exhibitor
1	Pfizer Limited
2	Taiwan Otsuka Pharmaceutical Co.,Ltd.
3	Eugene
4	Eisai Taiwan Inc.
5	Promed Instrument Co., Ltd.
6 & 7	Servier
8	Taiwan Alzheimer's Disease Association
9	32nd International Conference of Alzheimer's Disease International

Exhibition Opening Hours

Date	Time
Saturday, December 10, 2016	08:30-18:00
Sunday, December 11, 2016	08:30-16:30

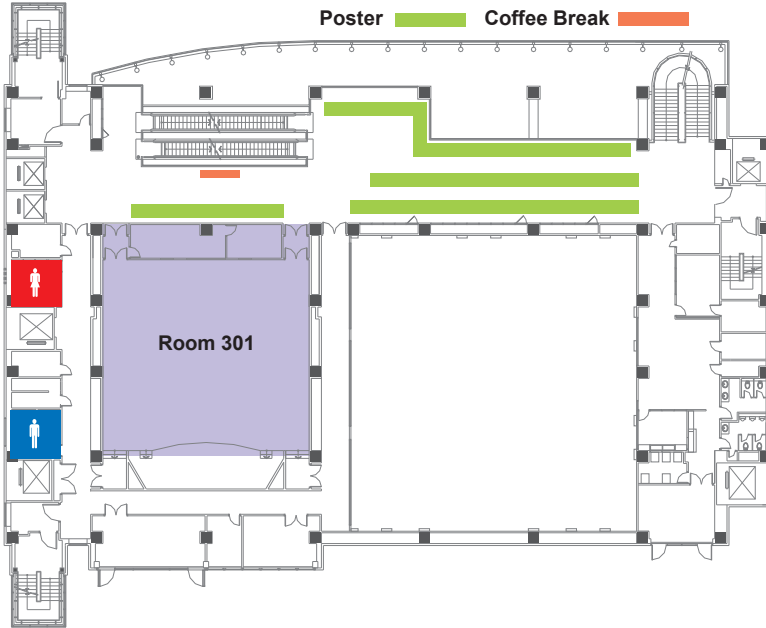

3F

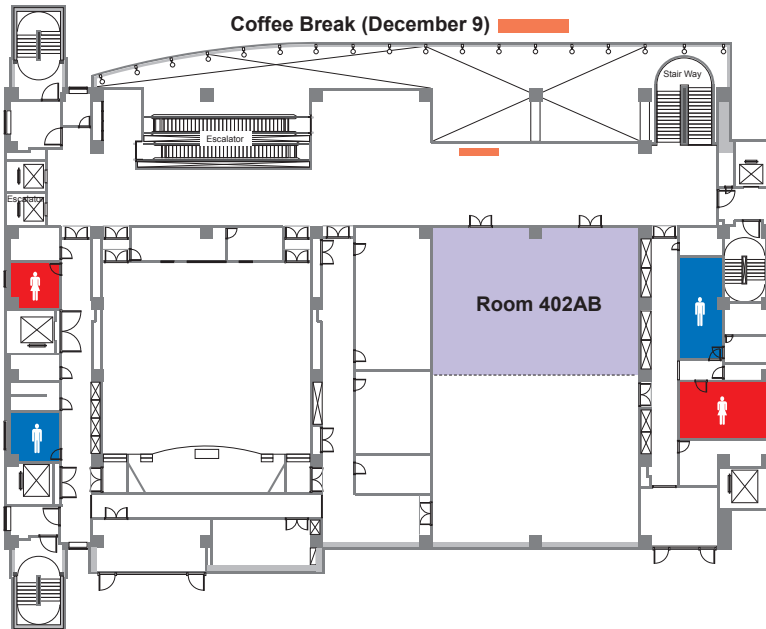

4F

Social Program

Opening Ceremony

Date	December 9, 2016 (Friday)
Time	17:00-17:30
Venue	Room 201, 2F (Meeting Venue)

Welcome Reception

Date	December 9, 2016 (Friday)
Time	18:30-20:00
Venue	Room 101, 1F (Meeting Venue)

Gala Dinner (Ticket Required)

Date	December 10, 2016 (Saturday)
Time	18:30-20:30
Venue	Room 101, 1F (Meeting Venue)

About Taipei

• Taipei 101

(Distance from the venue: 5.3km)

Taipei 101, with a mass of shops on the lower floors, incorporate many top brands under the LVMH group, such as Louis Vuitton, Dior, Celine, etc. The fourth floor houses the Page One bookstore from Singapore, with the highest-roofed coffee house in Taipei and many fine restaurants.

Metro: Taipei 101/World Trade Center

• National Chiang Kai-shek Memorial Hall

(Distance from the venue: 800m)

This memorial hall was built in memory of Chiang Kai-shek, the first president of the Republic of China. Work on the hall began in 1976, a year after President Chiang passed away. Design by C.C. Yang, who was also the architect for The Grand Hotel, the memorial hall is white with a blue roof, representing the dominant colors in the ROC flag; while the emblem of the Chinese Nationalist Party (KMT) adorns the vaulted ceiling. A bronze statue of Chiang looks west symbolically to the Presidential Office Building and mainland China. The front plaza of the hall is also a major venue for democratic assemblies.

Metro: Chiang Kai-Shek Memorial Hall



Taipei 101

National Chiang Kai-shek Memorial Hall





The Red House

- **The Red House**

(Distance from the venue: 2.3 km)

The two-story high red brick building is shaped into an octagonal cylinder. Each side of the octagon has a dormer window and a decorative wall. During the Japanese colonial era, the Red House was turned into a venue for Peking opera and crosstalk performances in the early 20th century. The place became a movie theater in the 1970s', ushering in the beginning of Ximending's cinema culture. Now the Red House is both a teahouse and a venue for small-scale theater productions.

Metro: Ximen

- **Longshan (lungshan) Temple**

(Distance from the venue: 2.9km)

Longshan (lungshan) Temple is a famous old temple in Taiwan. It is for worshipping Guanshiyin Buddha and other divine spirits. Its architecture is a three-section design in shape. There are the front hall, the rear hall and the right/left dragons protecting the middle hall. The layout is square and serene. The temple was built in Qianlong 5th year in Qing Dynasty. Due to natural disaster and damages caused by men, the temple was restored for several times. The doors, beams, and poles are beautifully decorated. There is a pair of bronze dragon poles in the front hall, four pairs of dragon poles in the middle hall. The sculptures are delicate. There are also exquisite wood sculptures. Among them, the well and Buddha setting in the main hall are highly appreciated. The temple has many Chinese poems, verses and lyrics on signs. These add a touch of literature in addition to the religious and sightseeing value.

Metro: Longshan Temple

Longshan (lungshan) Temple



• National Dr. Sun Yat-sen Memorial Hall

(Distance from the venue: 4.7km)

The National Dr. Sun Yat-sen Memorial Hall was built to commemorate the centenary birthday of Dr. Sun Yat-sen, founded in 1965, has been serving to provide the Taiwanese people a place of remembrance for the national founding father-Dr. Sun Yat-sen. It houses the internationally renowned national performance hall, and professional library with more than 300,000 collection of books. It is one of the most well-known sightseeing spots and multifunctional centers in Taipei.

Metro: Sun Yat-sen Memorial Hall

• National Martyrs' Shrine

(Distance from the venue: 5.0km)

Built on a green hillside in 1969, the impressive National Martyrs' Shrine was architecturally inspired by the Hall of Supreme Harmony in Beijing's Forbidden City. The shrine is dedicated to the 390,000 soldiers killed in the service of their country during the War of Resistance against Japan and the civil war between the Chinese Republican and communist forces. A major attraction at the shrine is the hourly ceremony for the changing of the honor guard in front of the main gate.

Metro: Dazhi



National Dr. Sun Yat-sen Memorial Hall



National Martyrs' Shrine



National Palace Museum



Shilin Night Market



Yangmingshan National Park

• National Palace Museum

(Distance from the venue: 10.2km)

The National Palace Museum houses the world's largest collection of priceless Chinese art treasures, one which spans China's nearly 5,000-year history. Most of the museum's 620,000 art objects were part of the Chinese imperial collection, which began over 1,000 years ago in the early Sung dynasty. National Palace Museum is protecting and preserving the 5000-year cultural legacy of China with advanced technologies; cooperating with private connoisseurs and ushering in exhibitions from China; bringing the Museum's collection to the global community and welcoming arts of the world to the Museum.

Metro: Shilin

• Shilin Night Market

(Distance from the venue: 6.5km)

The Shilin Night Market in Taipei is one of the largest, most popular night markets in Taiwan with regard to food, and also one of the most popular points of Taipei's night life among visitors. The maze of alleyways is filled with a variety of local, traditional, and international merchandise that attract locals and foreigners alike. Many of Taiwan's traditional foods can be found and bought for reasonable prices from the friendly locals who are eager to let you taste the unique flavours of their traditional recipes. It is one of the attractions that must be visited when in Taipei, the sites, scents and bargains are enough to plan a second visit - you can never get enough!

Metro: Jiantan

• Yangmingshan National Park

(Distance from the venue: 16.2km)

Of all Taiwan's national parks, Yangmingshan is the one located closest to a metropolitan center. Yangmingshan features a widely varying terrain, diverse ecology, and is home to numerous protected species. If you're lucky, you might even catch a glimpse of one of Taiwan's endemic bird species - the Formosan Blue Magpie.

Perhaps one of the most distinctive features in the park is the "Flower Clock," composed of a variety of colorful seasonal flowers. When visiting Yangmingshan, be sure to take a photo to prove you've seen this famous landmark! Also worth checking are popular sights like the Hsiao-you-keng ("Small Oil Pit"), Ching-tien-kang (Qing-tian Hill) Leng-shui-keng ("Cold Water Pit"), and Yangming Archive House. If you enjoy an invigorating hike, these will be right up your alley! The Yangmingshan area also possesses a wealth of geothermal resources, with hot springs having differing compositions depending on their location in the park. Nearby Xing-yi Road in Beitou is lined with hot spring restaurants.

Beautiful flowers in the spring, a cool getaway in the summer, silver grass and maple leaves in the fall, hot springs in the winter - Yangmingshan's distinctive seasonal offerings await your discovery!

Metro: Jiantan → Bus: Red 5



2016 IPA International Psychogeriatric Association
Asian Regional Meeting

9–11 December 2016, Taipei, Taiwan

Safety and Integrated Care in Aging Mental Health: Cross-cultural Perspective